



2150 - 106th Lane NE
Blaine, MN 55449
Toll Free: 800-801-0123
Fax: 763-717-0094
www.willoc.com



Dear Valued Customers,

As Wil-loc prepares to celebrate its 10th anniversary of business, I wanted to take this opportunity to thank all of you that have helped build our company into one of the largest suppliers of ball & socket couplings and pipe in the United States.

With your support over the past decade, Wil-loc has been able to build what we believe to be the most comprehensive line of quick-action industrial plumbing equipment available. Because of your loyalty to the Wil-loc product line, we have been able to expand our inventory levels to the largest in the nation, giving you the best access to the products you need at the very best price available.

Looking forward to our 10th year of business and beyond, Wil-loc continues our commitments to quality products and competitive pricing for you, our valued customer. At the same time, we are investing in our customer service capabilities and introducing new and innovative products to make your jobs more efficient and profitable.

Once again, I thank you for being a big part of our success, and look forward to servicing you for ten years to come.

Best Regards,

Will Blake

Will Blake
President



contents

Galvanized Fittings

| | |
|-------------------------|-------|
| hose sets | 1 & 3 |
| double hose connections | 1 & 3 |
| threaded npt | 5 & 9 |
| flanges | 7 & 9 |
| elbows | 11 |
| increasers | 13 |
| reducers | 13 |
| s-bends | 13 |
| t's | 15 |
| y's | 15 |
| end plugs | 17 |
| end caps | 17 |
| double males | 17 |
| double females | 17 |

Carbon Steel Weld-Ons

| | |
|------|---------|
| sets | 19 & 21 |
|------|---------|

Cast Aluminum Fittings

| | |
|--------------|----|
| weld-ons | 23 |
| hose sets | 24 |
| flanges | 25 |
| threaded npt | 25 |
| elbows | 26 |
| increasers | 26 |
| reducers | 26 |

Stainless Steel Fittings

| | |
|--------------|----|
| weld-ons | 27 |
| hose sets | 29 |
| flanges | 31 |
| threaded npt | 31 |
| elbows | 32 |
| increasers | 32 |
| reducers | 32 |

Pipe & HDPE

| | |
|-------------------------------------|----|
| galvanized pipe | 33 |
| aluminum pipe | 34 |
| fused high pressure hdpe fittings | 35 |
| press-in low pressure hdpe fittings | 36 |

Specialty

| | |
|---------------------|----|
| clamps | 37 |
| locking pins | 37 |
| valves | 38 |
| cam-lock adapters | 39 |
| victaulic adapters | 40 |
| ring-lock adapters | 40 |
| ban-lock adapters | 40 |
| wellpoint equipment | 41 |
| strainer baskets | 43 |
| custom fabrication | 44 |



Key Features and Benefits of the Wil-loc Coupling

- Quick pump connections decrease man-hours for pump installation/dismantling
- Ball and Socket design securely seated by O-Ring for vacuum-tight seal
- Durable construction provides years of use and decreases replacement costs
- Lever locking jaw can be secured with locking pin to prevent accidental or deliberate uncoupling
- Up to 30° coupling articulation allows for misaligned connections

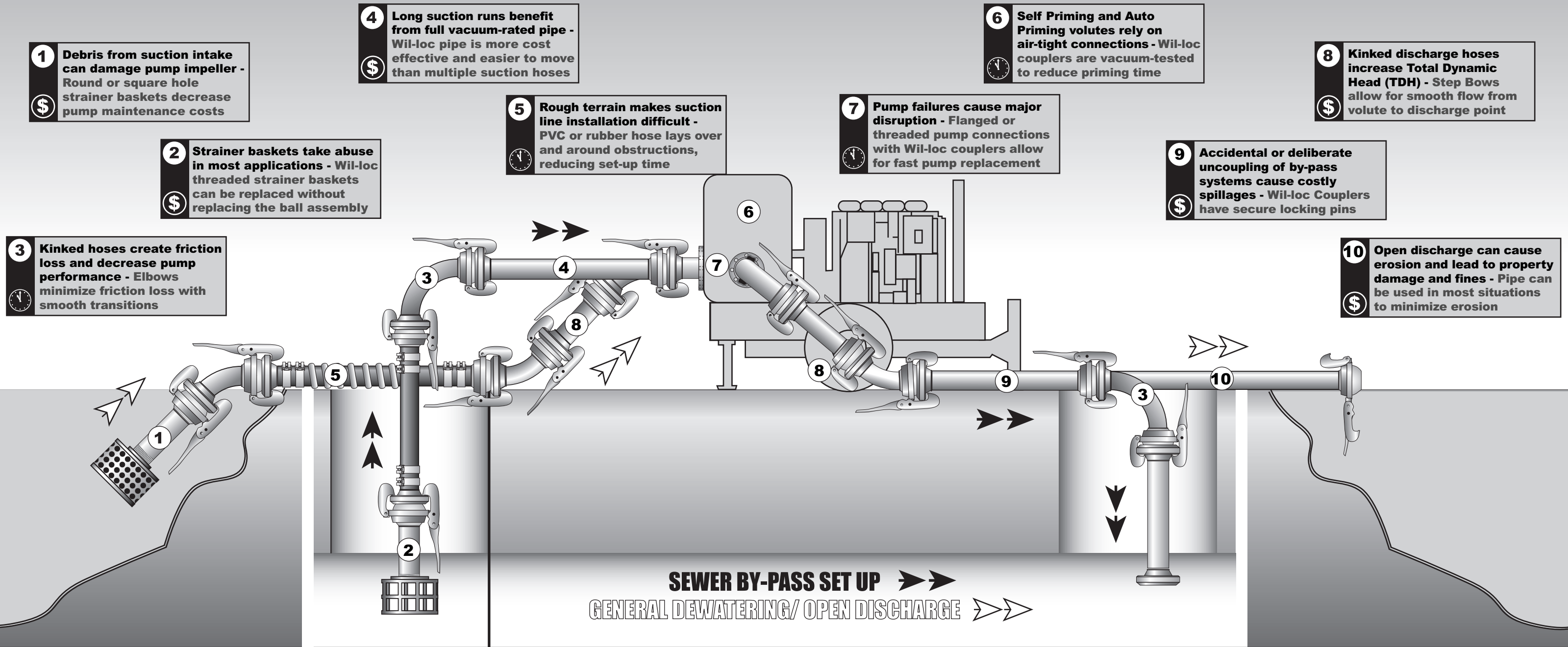

Wil-loc B-Style Assembly

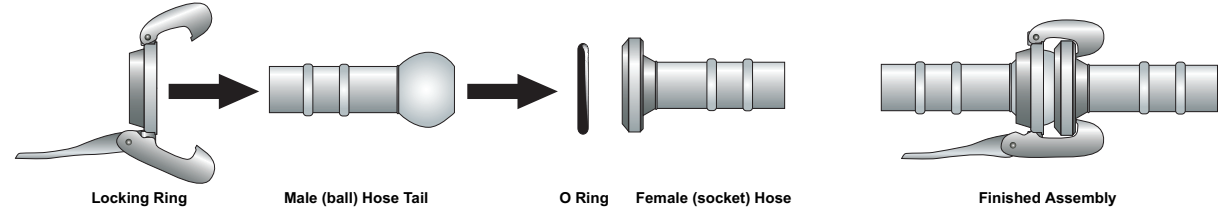

Wil-loc A-Style Assembly

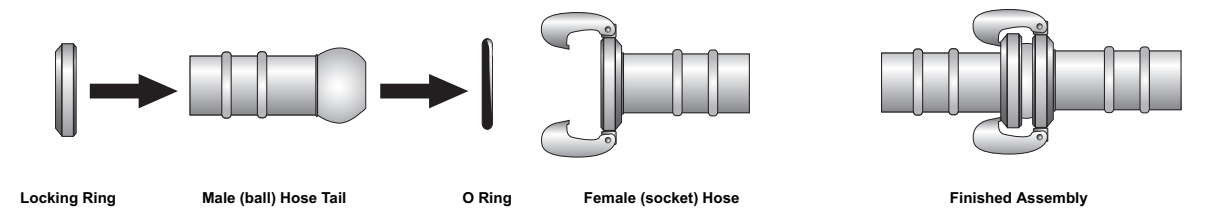

1



B-Style Galvanized Hose Sets specifications and usage

Prices and discount structures subject to change without notice.



| complete hose sets | part number | weight (lbs.) | list price |
|----------------------|-------------|---------------|------------|
| 2" Hose Set Assembly | 275 HSA2 | 2.60 | 38.05 |
| 3" Hose Set Assembly | 275 HSA3 | 5.30 | 59.40 |
| 4" Hose Set Assembly | 275 HSA4 | 11.70 | 106.25 |
| 5" Hose Set Assembly | 275 HSA5 | 16.50 | 145.90 |
| 6" Hose Set Assembly | 275 HSA6 | 21.70 | 189.40 |
| 8" Hose Set Assembly | 275 HSA8 | 35.70 | 369.75 |



| male hose ends | part number | weight (lbs.) | list price |
|------------------------|-------------|---------------|------------|
| 2" Hose Tail Ball/Male | 260 HTM2 | .75 | 11.13 |
| 3" Hose Tail Ball/Male | 260 HTM3 | 1.45 | 16.94 |
| 4" Hose Tail Ball/Male | 260 HTM4 | 3.75 | 32.85 |
| 5" Hose Tail Ball/Male | 260 HTM5 | 4.70 | 40.86 |
| 6" Hose Tail Ball/Male | 260 HTM6 | 5.85 | 51.99 |
| 8" Hose Tail Ball/Male | 260 HTM8 | 10.70 | 110.89 |



| female hose ends | part number | weight (lbs.) | list price |
|----------------------------|-------------|---------------|------------|
| 2" Hose Tail Socket/Female | 270 HTF2 | .75 | 11.19 |
| 3" Hose Tail Socket/Female | 270 HTF3 | 1.50 | 16.75 |
| 4" Hose Tail Socket/Female | 270 HTF4 | 3.50 | 31.87 |
| 5" Hose Tail Socket/Female | 270 HTF5 | 5.35 | 32.66 |
| 6" Hose Tail Socket/Female | 270 HTF6 | 6.60 | 56.77 |
| 8" Hose Tail Socket/Female | 270 HTF8 | 12.00 | 120.80 |



| galvanized locking levers | part number | weight (lbs.) | list price |
|---------------------------|-------------|---------------|------------|
| 2" Lever Locking Ring | 273 LR2 | 1.05 | 15.72 |
| 3" Lever Locking Ring | 273 LR3 | 2.35 | 25.69 |
| 4" Lever Locking Ring | 273 LR4 | 4.45 | 41.53 |
| 5" Lever Locking Ring | 273 LR5 | 6.40 | 59.88 |
| 6" Lever Locking Ring | 273 LR6 | 9.25 | 80.68 |
| 8" Lever Locking Ring | 273 LR8 | 13.00 | 138.05 |



| o-rings | part number | weight (lbs.) | list price |
|-----------|-------------|---------------|------------|
| 2" O-Ring | 280 OR2 | 0.05 | .80 |
| 3" O-Ring | 280 OR3 | 0.10 | 1.55 |
| 4" O-Ring | 280 OR4 | 0.20 | 2.70 |
| 5" O-Ring | 280 OR5 | 0.40 | 5.50 |
| 6" O-Ring | 280 OR6 | 0.50 | 6.00 |
| 8" O-Ring | 280 OR8 | 0.55 | 11.00 |



| double hose connections | part number | weight (lbs.) | list price |
|---------------------------|-------------|---------------|------------|
| 2" Double Hose Connection | 278 DHC2 | 1.00 | 12.78 |
| 3" Double Hose Connection | 278 DHC3 | 1.15 | 19.33 |
| 4" Double Hose Connection | 278 DHC4 | 4.10 | 33.83 |
| 6" Double Hose Connection | 278 DHC6 | 7.10 | 54.32 |
| 8" Double Hose Connection | 278 DHC8 | 11.85 | 105.57 |

1.800.801.0123

www.willoc.com

2

Wil-loc Male B-Style Hose Tails

| | | | |
|---------------|------------------|----------------|----------------|
| vacuum rating | 30 inches hg | number of ribs | 2 & 3 inch = 2 |
| psi rating | 2 & 3 inch = 290 | | 4 - 8 inch = 3 |
| | 4 - 8 inch = 175 | | |

| lever mechanical specs. | A | B | C | D | E |
|-------------------------|-------|------|-------|-------|------|
| 2" 50x50mm | 7.09 | 3.35 | 4.92 | 3.94 | 2.44 |
| 3" 76x76mm | 9.25 | 3.54 | 7.09 | 5.31 | 3.43 |
| 4" 108x100mm | 10.83 | 6.69 | 9.25 | 7.48 | 5.20 |
| 5" 133x125mm | 11.41 | 5.51 | 10.83 | 8.07 | 5.91 |
| 6" 159x150mm | 13.39 | 6.30 | 11.81 | 9.06 | 6.69 |
| 8" 194x200mm | 13.19 | 9.06 | 13.98 | 10.04 | 8.66 |

Hose Set Specifications to 1/100th of an inch • Specifications Subject to Change

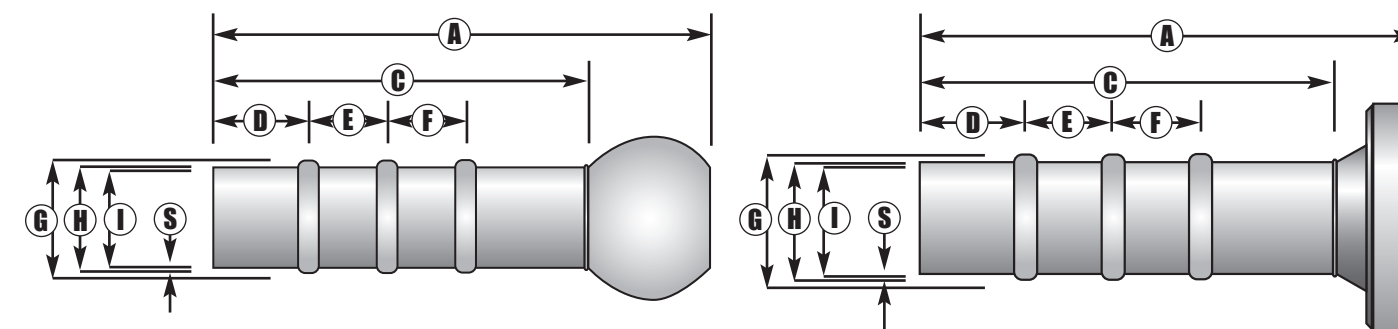
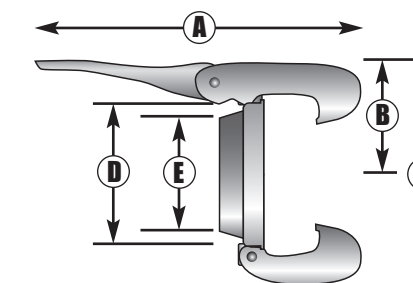

| male mechanical specs. | A | C | D | E | F | G | H | I | S |
|------------------------|-------|------|------|------|------|------|------|------|------|
| 2" 50x50mm | 6.50 | 4.33 | 0.98 | 1.38 | | 2.09 | 1.97 | 1.85 | 0.06 |
| 3" 76x76mm | 8.07 | 5.31 | 1.38 | 1.38 | | 3.11 | 2.99 | 2.87 | 0.06 |
| 4" 108x100mm | 11.42 | 7.28 | 1.38 | 1.77 | 1.77 | 4.09 | 3.94 | 3.80 | 0.07 |
| 5" 133x125mm | 11.61 | 7.87 | 1.38 | 1.77 | 1.77 | 5.08 | 4.92 | 4.78 | 0.07 |
| 6" 159x150mm | 12.40 | 8.46 | 1.57 | 1.97 | 1.97 | 6.06 | 5.91 | 5.77 | 0.07 |
| 8" 194x200mm | 14.96 | 9.84 | 1.97 | 2.36 | 2.36 | 8.11 | 7.87 | 7.71 | 0.08 |

Hose Set Specifications to 1/100th of an inch • Specifications Subject to Change

| female mechanical specs. | A | C | D | E | F | G | H | I | S |
|--------------------------|-------|------|------|------|------|------|------|------|------|
| 2" 50x50mm | 5.51 | 4.33 | 0.98 | 1.38 | | 2.09 | 1.97 | 1.85 | 0.06 |
| 3" 76x76mm | 6.69 | 5.31 | 1.38 | 1.38 | | 3.11 | 2.99 | 2.87 | 0.06 |
| 4" 108x100mm | 9.45 | 7.28 | 1.38 | 1.77 | 1.77 | 4.09 | 3.94 | 3.80 | 0.07 |
| 5" 133x125mm | 10.04 | 7.87 | 1.38 | 1.77 | 1.77 | 5.08 | 4.92 | 4.78 | 0.07 |
| 6" 159x150mm | 10.43 | 8.46 | 1.57 | 1.97 | 1.97 | 6.06 | 5.91 | 5.77 | 0.07 |
| 8" 194x200mm | 12.99 | 9.84 | 1.97 | 2.36 | 2.36 | 8.11 | 7.87 | 7.71 | 0.08 |

Hose Set Specifications to 1/100th of an inch • Specifications Subject to Change

Tech Tip

Wil-loc Couplings have a higher working pressure rating than typical Cam-lock or other quick action couplings. Typical Cam-lock: 2" = 250psi, 3" = 125psi, 4" = 100psi, 5" = 75psi and 6" = 75 psi. Check with your manufacturer for specific ratings.

3



A-Style Galvanized Hose Sets specifications and usage

Prices and discount structures subject to change without notice.



10" hose set shown.

| complete hose sets | part number | weight (lbs.) | list price |
|--------------------------------------------------|-------------|---------------|------------|
| 10" Hose Set Assembly | 276 HSA10 | 55.04 | 434.35 |
| 12" Hose Set Assembly* | 276 HSA12 | 89.60 | 721.80 |
| * 12" Hose Set Assembly comes with a locking bar | | | |

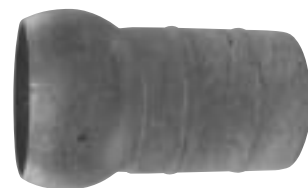

| male hose tails | part number | weight (lbs.) | list price |
|---------------------------------------------------------------|-------------|---------------|------------|
| 10" Hose Tail Ball / Male | 261 HTM10 | 28.06 | 220.01 |
| 12" Hose Tail Ball / Male | 261 HTM12 | 43.55 | 337.09 |
| all 10 and 12 inch a-style hose sets come with a locking ring | | | |



10" female shown.

| female hose tails | part number | weight (lbs.) | list price |
|--------------------------------------------------|-------------|---------------|------------|
| 10" Hose Tail Socket | 271 HTF10 | 25.25 | 214.33 |
| 12" Hose Tail Socket* | 271 HTF12 | 44.50 | 384.74 |
| * 12" Hose Set Assembly comes with a locking bar | | | |



| galvanized locking rings | part number | weight (lbs.) | list price |
|--------------------------|-------------|---------------|------------|
| 10" Locking Ring | 251 G10R | 8.15 | 54.25 |
| 12" Locking Ring | 251 G12R | 14.15 | 94.14 |



| o-rings | part number | weight (lbs.) | list price |
|------------|-------------|---------------|------------|
| 10" O-ring | 281 OR10 | 1.05 | 12.60 |
| 12" O-ring | 281 OR12 | 1.55 | 14.50 |



| double end connection | part number | weight (lbs.) | list price |
|----------------------------|-------------|---------------|------------|
| 10" Double Hose Connection | 278 DHC10 | | CALL |
| 12" Double Hose Connection | 278 DHC12 | 25.70 | 230.84 |

1.800.801.0123

www.willoc.com

4

Wil-loc A-Style Hose Tails

| | |
|-----------------|--------------|
| vacuum rating | 30 inches hg |
| pressure rating | 88 psi |
| number of ribs | 2 |

A-Style Locking Ring

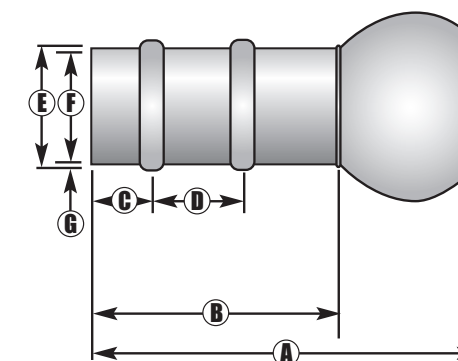

| male mechanical specs. | A | B | C | D | E | F | G |
|----------------------------------------------------------------------------------|-------|-------|------|------|-------|-------|------|
| 10" 250mm x 150mm | 18.54 | 11.81 | 3.54 | 4.72 | 10.08 | 9.84 | 0.98 |
| 12" 300mm x 300mm | 18.54 | 11.81 | 3.54 | 4.72 | 12.05 | 11.81 | 0.98 |
| Hose Set Specifications to 1/100th of an inch • Specifications Subject to Change | | | | | | | |



12" Female Hose Tail



10" Female Hose Tail

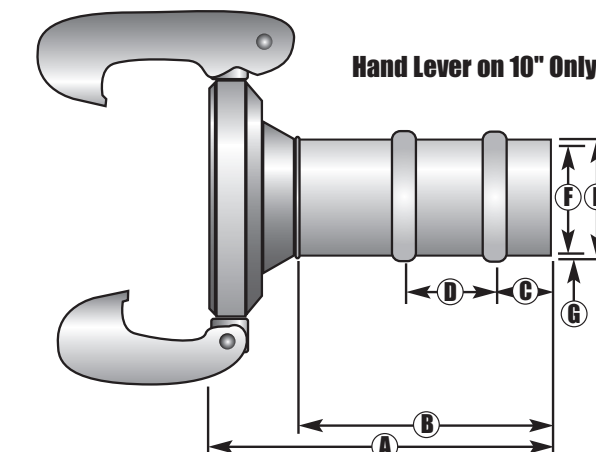

Hand Lever on 10" Only.

| female mechanical specs. | A | B | C | D | E | F | G |
|----------------------------------------------------------------------------------|-------|-------|------|------|-------|-------|------|
| 10" 250mm x 150mm | 16.14 | 11.81 | 3.54 | 4.72 | 10.08 | 9.84 | 0.98 |
| 12" 300mm x 300mm | 16.89 | 11.81 | 3.54 | 4.72 | 12.05 | 11.81 | 0.98 |
| Hose Set Specifications to 1/100th of an inch • Specifications Subject to Change | | | | | | | |

Tech Tip

For easier coupling (especially of larger sizes) lubricate new Wil-loc O-rings. This will allow the ball to seat into the socket easier during first time usage.

Double hose connections provide a quick, inexpensive way to repair leaks in the field. Cut the leak area out of the lay-flat hose, insert the double hose connection and use two Wil-loc T-Bolt clamps per end to clamp the lay-flat onto double connection.



| male threaded long balls | part number | weight (lbs.) | list price |
|-----------------------------|-------------|---------------|------------|
| 2" Male Thrd/Long/Ball/Male | 020 BMT2 | 3.10 | 40.55 |
| 3" Male Thrd/Long/Ball/Male | 020 BMT3 | 6.10 | 62.25 |
| 4" Male Thrd/Long/Ball/Male | 020 BMT4 | 10.60 | 109.80 |
| 6" Male Thrd/Long/Ball/Male | 020 BMT6 | 21.15 | 202.86 |
| 8" Male Thrd/Long/Ball/Male | 020 BMT8 | 37.60 | 388.19 |



| male threaded short balls | part number | weight (lbs.) | list price |
|------------------------------|-------------|---------------|------------|
| 2" Male Thrd/Short/Ball/Male | 022 BMT2 | 2.05 | 35.59 |
| 3" Male Thrd/Short/Ball/Male | 022 BMT3 | 4.05 | 52.76 |
| 4" Male Thrd/Short/Ball/Male | 022 BMT4 | 7.90 | 96.35 |
| 6" Male Thrd/Short/Ball/Male | 022 BMT6 | 15.20 | 171.49 |
| 8" Male Thrd/Short/Ball/Male | 022 BMT8 | 25.75 | 311.79 |



| female threaded balls | part number | weight (lbs.) | list price |
|--------------------------|-------------|---------------|------------|
| 2" Female Thrd Ball/Male | 025 BFTA2 | 3.05 | 49.95 |
| 3" Female Thrd Ball/Male | 025 BFTA3 | 7.45 | 97.68 |
| 4" Female Thrd Ball/Male | 025 BFTA4 | 12.50 | 143.31 |
| 6" Female Thrd Ball/Male | 025 BFTA6 | 26.65 | 349.33 |
| 8" Female Thrd Ball/Male | 025 BFTA8 | 49.70 | 599.24 |



| male threaded sockets | part number | weight (lbs.) | list price |
|----------------------------|-------------|---------------|------------|
| 2" Male Thrd Socket/Female | 040 SMT2 | 0.95 | 19.72 |
| 3" Male Thrd Socket/Female | 040 SMT3 | 1.60 | 26.60 |
| 4" Male Thrd Socket/Female | 040 SMT4 | 3.50 | 54.12 |
| 6" Male Thrd Socket/Female | 040 SMT6 | 6.95 | 94.05 |
| 8" Male Thrd Socket/Female | 040 SMT8 | 13.60 | 184.82 |



| female threaded sockets | part number | weight (lbs.) | list price |
|---------------------------|-------------|---------------|------------|
| 2" Female Thrd Skt/Female | 045 SFTA2 | 2.00 | 34.08 |
| 3" Female Thrd Skt/Female | 045 SFTA3 | 4.95 | 71.52 |
| 4" Female Thrd Skt/Female | 045 SFTA4 | 8.05 | 101.08 |
| 6" Female Thrd Skt/Female | 045 SFTA6 | 18.15 | 271.89 |
| 8" Female Thrd Skt/Female | 045 SFTA8 | 37.55 | 472.27 |

Wil-loc NPT Threaded Fittings

vacuum rating 30 inches hg
pressure rating 2 – 3" = 290 psi, 4 – 8" = 175 psi

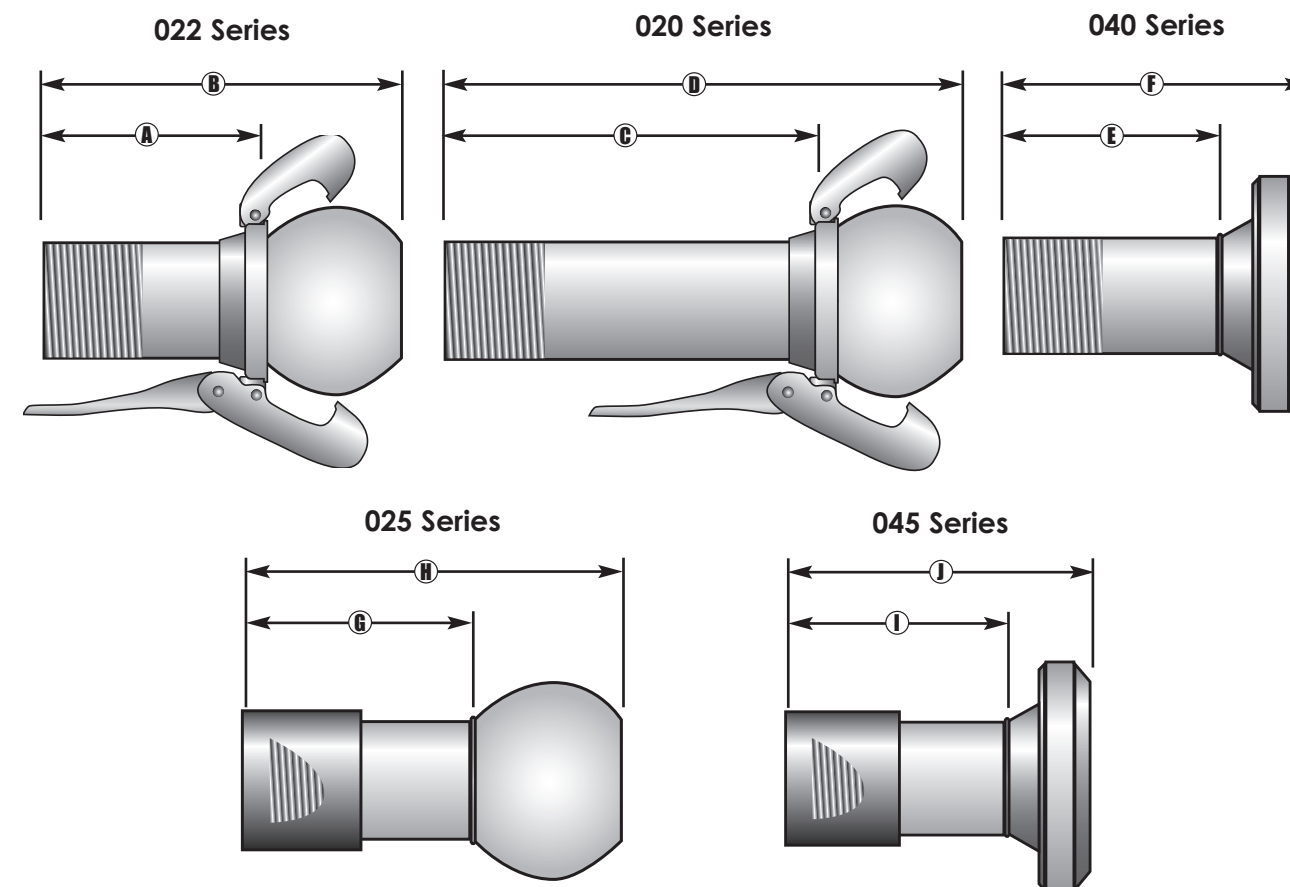

| npt mechanical specs. | A | B | C | D | E | F | G | H | I | J |
|-----------------------|------|------|------|-------|------|------|------|-------|------|-------|
| 2" 50mm x 50mm | 2.76 | 4.92 | 5.51 | 7.67 | 2.76 | 3.98 | 4.35 | 6.50 | 4.35 | 5.50 |
| 3" 76mm x 76mm | 2.76 | 5.59 | 6.69 | 9.53 | 2.76 | 4.13 | 4.62 | 7.50 | 4.62 | 6.00 |
| 4" 108mm x 100mm | 2.76 | 7.00 | 6.69 | 10.94 | 2.76 | 4.92 | 5.42 | 9.63 | 5.42 | 7.50 |
| 6" 159mm x 150mm | 3.94 | 8.03 | 9.45 | 13.54 | 3.94 | 5.91 | 6.89 | 11.00 | 6.89 | 8.87 |
| 8" 194mm x 200mm | 3.94 | 9.17 | 9.06 | 14.29 | 3.94 | 7.17 | 8.22 | 13.50 | 8.22 | 11.50 |

Specifications to 1/8th of an inch • Specifications Subject to Change

Tech Tip

Wil-loc offers two different threaded shanks for the male connections. The 020 Series allows the locking ring lever to close above the male NPT threads. The 022 Series locking lever closes below the male NPT threads. Check application clearance before choosing the correct fit.

Before installing a Wil-loc Threaded Fitting, apply an all-purpose anti-seize product to threads. If the fitting should have to be removed from the pump, the anti-seize product can prevent seizure of the threads.



| discharge flanges | part number | weight (lbs.) | list price |
|-------------------------------|-------------|---------------|------------|
| 3" Flange Ball/Male Discharge | 010 F3M | 8.60 | 107.10 |
| 4" Flange Ball/Male Discharge | 010 F4M | 14.10 | 158.78 |
| 6" Flange Ball/Male Discharge | 010 F6M | 24.20 | 297.28 |
| 8" Flange Ball/Male Discharge | 010 F8M | 34.20 | 466.66 |

All flanges are designed to ASA 150 series hole specifications.

| suction flanges | part number | weight (lbs.) | list price |
|------------------------------|-------------|---------------|------------|
| 3" Flange Socket/Fem Suction | 030 F3F | 5.50 | 83.57 |
| 4" Flange Socket/Fem Suction | 030 F4F | 8.95 | 110.42 |
| 6" Flange Socket/Fem Suction | 030 F6F | 13.20 | 206.77 |
| 8" Flange Socket/Fem Suction | 030 F8F | 20.90 | 313.71 |

All flanges are designed to ASA 150 series hole specifications.

| neoprene gaskets | part number | weight (lbs.) | list price |
|----------------------------|-------------|---------------|------------|
| 3" Flange Gasket Neoprene | 288 FGN3 | 0.20 | 5.00 |
| 4" Flange Gasket Neoprene | 288 FGN4 | 0.30 | 8.00 |
| 6" Flange Gasket Neoprene | 288 FGN6 | 0.35 | 12.00 |
| 8" Flange Gasket Neoprene | 288 FGN8 | 0.35 | 16.50 |
| 10" Flange Gasket Neoprene | 289 FGN10 | 0.50 | 21.60 |
| 12" Flange Gasket Neoprene | 289 FGN12 | 0.65 | 30.00 |

1/4" thickness / full faced

| increasing flanges | part number | weight (lbs.) | list price |
|-----------------------|-------------|---------------|------------|
| 4" Flange x 6" Male | 033 F4-6M | 14.00 | 269.67 |
| 6" Flange x 8" Male | 033 F6-8M | 49.75 | 408.81 |
| 4" Flange x 6" Female | 032 F4-6F | 24.75 | 144.95 |
| 6" Flange x 8" Female | 032 F6-8F | 19.00 | 213.07 |

All flanges are designed to ASA 150 series hole specifications.

| reducing flanges | part number | weight (lbs.) | list price |
|-----------------------|-------------|---------------|------------|
| 6" Flange x 4" Male | 033 F6-4M | 21.25 | 239.77 |
| 8" Flange x 6" Male | 033 F8-6M | 41.75 | 362.91 |
| 6" Flange x 4" Female | 032 F6-4F | 12.00 | 148.07 |
| 8" Flange x 6" Female | 032 F8-6F | 20.00 | 215.55 |

All flanges are designed to ASA 150 series hole specifications.

Wil-loc Flanges

| | |
|-----------------|------------------------------------------------|
| vacuum | 30 inches hg |
| flange pattern | ASA 150 |
| number of holes | 3" has 4 bolt holes 4 – 8" has 8 bolt holes |
| pressure rating | 3" = 290 psi, 4 – 8" = 175 psi |

| male flange specs. | A | B | C |
|--------------------|-------|------|------|
| 3" Male Flange | 10.00 | 6.50 | 2.88 |
| 4" Male Flange | 11.88 | 7.00 | 3.50 |
| 6" Male Flange | 13.63 | 9.00 | 4.00 |
| 8" Male Flange | 15.63 | 9.88 | 5.25 |

Specifications to 1/8th of an inch & Subject to Change

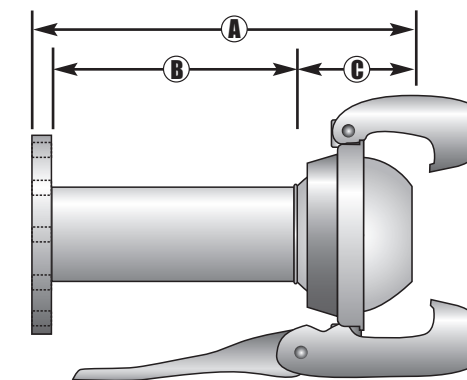

| female flange specs. | A | B | C |
|----------------------|------|------|------|
| 3" Female Flange | 4.63 | 2.75 | 1.38 |
| 4" Female Flange | 6.50 | 4.00 | 2.25 |
| 6" Female Flange | 6.50 | 4.00 | 2.25 |
| 8" Female Flange | 7.75 | 4.00 | 3.25 |

Specifications to 1/8th of an inch & Subject to Change

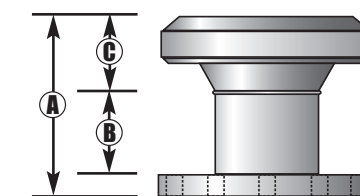

| ASA flange specs. | A | B | C |
|-------------------|-------|-------|-------|
| 3" ASA 150 Flange | 7.50 | 6.00 | 0.75 |
| 4" ASA 150 Flange | 9.00 | 7.50 | 0.75 |
| 6" ASA 150 Flange | 11.00 | 9.50 | 0.875 |
| 8" ASA 150 Flange | 13.50 | 11.95 | 0.875 |

Specifications to 1/8th of an inch & Subject to Change

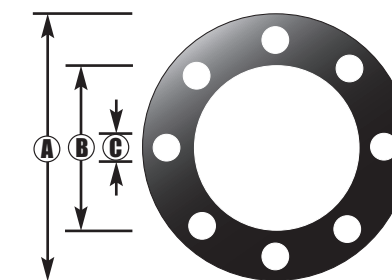

Tech Tip

Wil-loc Flange Fittings are manufactured to ASA 150 pattern specifications. Gaskets should be used when mounting the flange fittings to a pump. If your pumps require other flange types or sizes, please contact your Wil-loc representative or dealer.

Wil-loc Increasing Flanges allow quick connection of high flow pumps to larger discharge lines. Higher flows can be achieved because larger diameter pipe decreases friction losses.



| male pump flanges | part number | weight (lbs.) | list price |
|--------------------------------|-------------|---------------|------------|
| 10" Flange Ball/Male Discharge | 011 F10M | 41.70 | 490.22 |
| 12" Flange Ball/Male Discharge | 011 F12M | 62.90 | 690.42 |

All flanges are designed to ASA hole specifications.



| female pump flanges | part number | weight (lbs.) | list price |
|-------------------------------|-------------|---------------|------------|
| 10" Flange Socket/Fem Suction | 031 F10F | 42.00 | 475.65 |
| 12" Flange Socket/Fem Suction | 031 F12F | 73.45 | 787.29 |

All flanges are designed to ASA hole specifications.



| increasing & reducing balls | part number | weight (lbs.) | list price |
|-----------------------------|-------------|---------------|------------|
| 10" Flange x 12" Male | 034 F10-12M | 90.00 | 547.62 |
| 12" Flange x 10" Male | 034 F12-10M | 54.75 | 522.67 |

All flanges are designed to ASA hole specifications.

B-style coupling shown.



| increasing & reducing sockets | part number | weight (lbs.) | list price |
|-------------------------------|-------------|---------------|------------|
| 10" Flange x 12" Female | 035 F10-12F | 93.00 | 721.07 |
| 12" Flange x 10" Female | 035 F12-10F | 53.50 | 607.19 |

All flanges are designed to ASA hole specifications.

B-style coupling shown.



| threaded discharge balls | part number | weight (lbs.) | list price |
|-----------------------------|-------------|---------------|------------|
| 10" Male Threaded Ball/Male | 021 BMT10 | 42.00 | 700.11 |
| 12" Male Threaded Ball/Male | 021 BMT12 | 56.00 | 997.98 |

Threads are cut to NPT specifications.

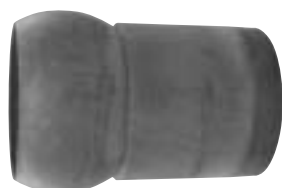

| threaded suction sockets | part number | weight (lbs.) | list price |
|--------------------------|-------------|---------------|------------|
| 10" Male Thrd Skt/Female | 041 SMT10 | 33.00 | 695.79 |
| 12" Male Thrd Skt/Female | 041 SMT12 | 58.00 | 1036.23 |

Price includes Locking Ring.

Wil-loc Flanges

| | |
|-----------------|---------------|
| vacuum | 30 inches hg |
| pressure rating | 88 psi |
| flange pattern | ASA 150 |
| number of holes | 12 bolt holes |
| thread pattern | NPT |

Hand lever on 10" only.

| a-style flange specs. | A | B | C |
|-----------------------|-------|-------|------|
| 10" Flange Balls | 13.25 | 6.00 | 6.75 |
| 12" Flange Balls | 15.00 | 6.00 | 8.38 |
| 10" Flange Sockets | 10.88 | 6.90 | 4.38 |
| 12" Flange Sockets | 21.75 | 16.00 | 5.75 |

Specifications to 1/8th of an inch & Subject to Change

| a-style NPT specs. | A | B | C |
|----------------------|-------|-------|------|
| 10" Threaded Balls | 17.75 | 12.25 | 6.75 |
| 12" Threaded Balls | 20.50 | 12.25 | 8.38 |
| 10" Threaded Sockets | 15.75 | 12.00 | 4.37 |
| 12" Threaded Sockets | 17.00 | 12.00 | 5.75 |

Specifications to 1/8th of an inch & Subject to Change

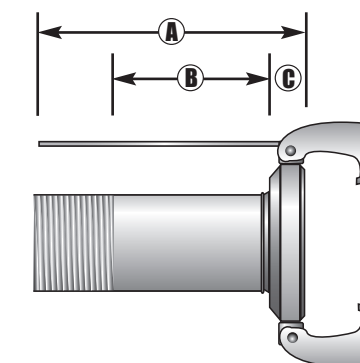
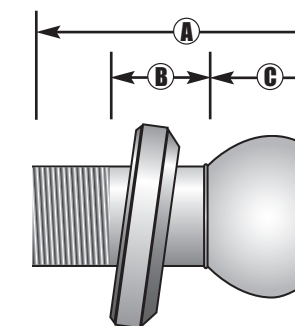
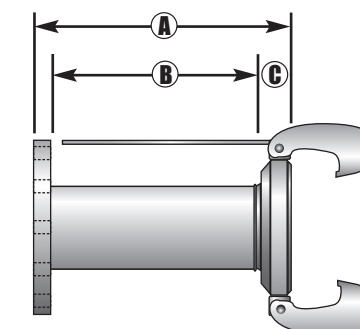
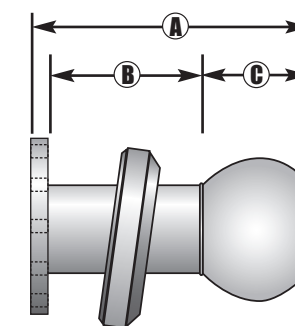

Tech Tip

The quick action and flexibility of 10" and 12" Wil-loc Couplings provides the end user with significant advantages over Victaulic or flanged methods previously used on large line applications.

Wil-loc full-face Neoprene Gaskets provide superior sealing and longevity compared to half-face flange gaskets.



| 90° elbow | part number | weight (lbs.) | list price |
|--------------------|-------------|---------------|------------|
| 2" 90 Degree Elbow | 070 E2-90 | 3.05 | 50.34 |
| 3" 90 Degree Elbow | 070 E3-90 | 5.35 | 69.75 |
| 4" 90 Degree Elbow | 070 E4-90 | 11.00 | 115.67 |
| 6" 90 Degree Elbow | 070 E6-90 | 21.00 | 219.35 |
| 8" 90 Degree Elbow | 070 E8-90 | 33.00 | 394.31 |



| 60° elbow | part number | weight (lbs.) | list price |
|--------------------|-------------|---------------|------------|
| 2" 60 Degree Elbow | 075 E2-60 | 3.00 | 50.34 |
| 3" 60 Degree Elbow | 075 E3-60 | 4.05 | 69.75 |
| 4" 60 Degree Elbow | 075 E4-60 | 10.05 | 115.67 |
| 6" 60 Degree Elbow | 075 E6-60 | 20.00 | 219.35 |
| 8" 60 Degree Elbow | 075 E8-60 | 26.00 | 394.31 |



| 45° elbow | part number | weight (lbs.) | list price |
|--------------------|-------------|---------------|------------|
| 2" 45 Degree Elbow | 080 E2-45 | 2.05 | 47.16 |
| 3" 45 Degree Elbow | 080 E3-45 | 4.00 | 65.22 |
| 4" 45 Degree Elbow | 080 E4-45 | 11.00 | 107.26 |
| 6" 45 Degree Elbow | 080 E6-45 | 19.05 | 197.71 |
| 8" 45 Degree Elbow | 080 E8-45 | 29.75 | 345.51 |



| 30° elbow | part number | weight (lbs.) | list price |
|--------------------|-------------|---------------|------------|
| 2" 30 Degree Elbow | 085 E2-30 | 3.00 | 47.16 |
| 3" 30 Degree Elbow | 085 E3-30 | 3.75 | 65.22 |
| 4" 30 Degree Elbow | 085 E4-30 | 10.00 | 107.26 |
| 6" 30 Degree Elbow | 085 E6-30 | 17.75 | 197.71 |
| 8" 30 Degree Elbow | 085 E8-30 | 30.00 | 345.51 |



45° a-style elbow

| a-style 90° elbow | part number | weight (lbs.) | list price |
|----------------------|-------------|---------------|------------|
| 10" 90 Degree Elbow | 086 E10-90 | 50.00 | 456.00 |
| 12" 90 Degree Elbow* | 086 E12-90 | 81.00 | 724.52 |

*12" sockets come with a closing bar

| a-style 45° elbow | part number | weight (lbs.) | list price |
|----------------------|-------------|---------------|------------|
| 10" 45 Degree Elbow | 086 E10-45 | 44.00 | 366.85 |
| 12" 45 Degree Elbow* | 086 E12-45 | 71.75 | 621.17 |

*12" sockets come with a closing bar

Wil-loc Elbows

| | |
|-----------------|-----------------------------------------------------------|
| vacuum | 30 inches hg |
| pressure rating | 2 – 3" = 290 psi 4 – 8" = 175 psi 10 – 12" = 88 psi |

| 90° elbow specs. | A | B |
|---------------------|-------|-------|
| 2" 90 Degree Elbow | 7.91 | 8.86 |
| 3" 90 Degree Elbow | 9.33 | 10.75 |
| 4" 90 Degree Elbow | 12.95 | 14.84 |
| 6" 90 Degree Elbow | 18.58 | 20.59 |
| 8" 90 Degree Elbow | 16.38 | 18.39 |
| 10" 90 Degree Elbow | 17.72 | 20.12 |
| 12" 90 Degree Elbow | 18.31 | 21.73 |

Specifications to 1/8th of an inch & Subject to Change

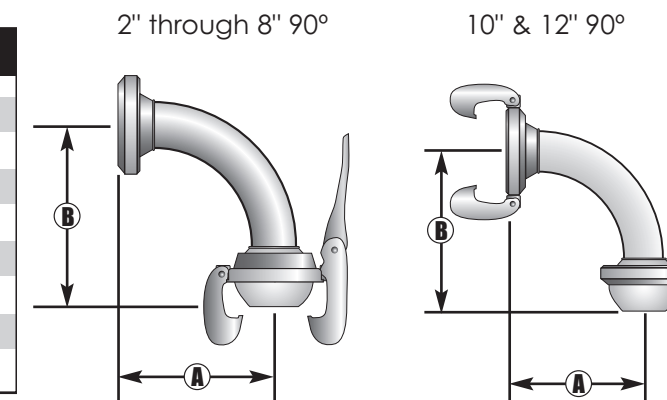

| 30°, 45° & 60° specs. | 30° | 45° | 60° |
|-----------------------|-------|-------|-------|
| 2" Elbows | 9.07 | 8.07 | 6.69 |
| 3" Elbows | 11.02 | 9.84 | 8.27 |
| 4" Elbows | 15.75 | 14.17 | 9.45 |
| 6" Elbows | 20.47 | 17.72 | 14.37 |
| 8" Elbows | 19.69 | 17.52 | 14.76 |
| 10" Elbows | 22.64 | 20.47 | 17.72 |
| 12" Elbows | 24.80 | 22.83 | 20.08 |

Specifications to 1/8th of an inch & Subject to Change

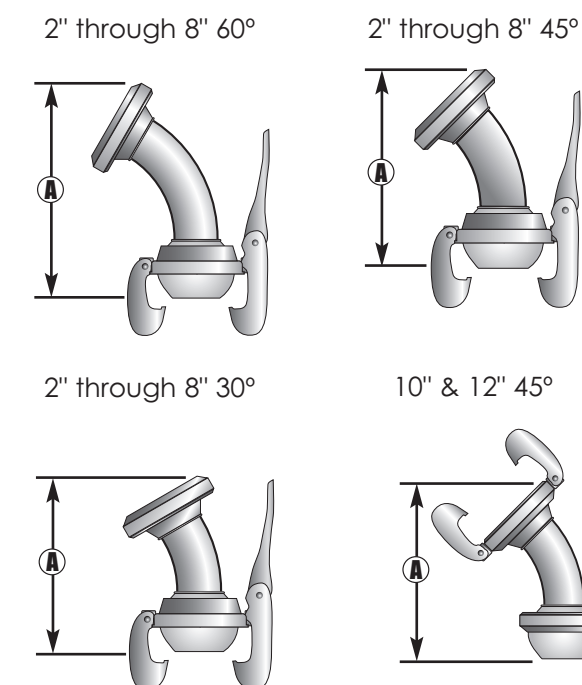

Tech Tip

When connecting ball and socket coupled hoses and fittings to a pump, position the locking jaws of the lever locking ring as close to 12 o'clock and 6 o'clock (in other words, top and bottom) as possible.

Wil-loc Elbows allow smooth transitions through bends and turns on suction or discharge lines. Using Wil-loc Elbows will reduce the wear of your hose and eliminate flow restrictions caused by kinking of lay-flat hose.



B-style coupling shown.



B-style coupling shown.

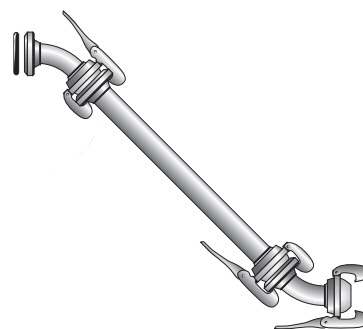

| increasers | part number | weight (lbs.) | list price |
|-------------------|-------------|---------------|------------|
| 2" x 3" Increaser | 150 IN2-3M | 4.50 | 62.43 |
| 2" x 4" Increaser | 150 IN2-4M | 6.85 | 126.68 |
| 3" x 4" Increaser | 150 IN3-4M | 7.75 | 129.73 |
| 3" x 6" Increaser | 150 IN3-6M | 14.05 | 200.83 |
| 4" x 6" Increaser | 150 IN4-6M | 15.00 | 168.84 |
| 4" x 8" Increaser | 150 IN4-8M | 21.75 | 328.33 |
| 6" x 8" Increaser | 150 IN6-8M | 24.40 | 298.96 |

| a-style increasers | part number | weight (lbs.) | list price |
|----------------------|--------------|---------------|------------|
| 8" x 10" Increaser | 151 IN8-10M | 50.00 | 366.02 |
| 8" x 12" Increaser* | 151 IN8-12M | 74.00 | 445.09 |
| 10" x 12" Increaser* | 151 IN10-12M | 98.50 | 565.93 |

*12" sockets come with a closing bar

| reducers | part number | weight (lbs.) | list price |
|-----------------|-------------|---------------|------------|
| 3" x 2" Reducer | 160 R3-2M | 2.65 | 53.38 |
| 4" x 3" Reducer | 160 R4-3M | 5.65 | 123.03 |
| 6" x 2" Reducer | 160 R6-2M | 6.60 | 140.20 |
| 6" x 3" Reducer | 160 R6-3M | 7.35 | 152.83 |
| 6" x 4" Reducer | 160 R6-4M | 10.95 | 136.40 |
| 8" x 2" Reducer | 160 R8-2M | 9.40 | 215.04 |
| 8" x 3" Reducer | 160 R8-3M | 11.00 | 219.07 |
| 8" x 4" Reducer | 160 R8-4M | 15.65 | 246.24 |
| 8" x 6" Reducer | 160 R8-6M | 21.85 | 242.23 |

| a-style reducers | part number | weight (lbs.) | list price |
|--------------------|-------------|---------------|------------|
| 10" x 8" Reducer | 161 R10-8M | 71.30 | 375.96 |
| 12" x 8" Reducer* | 161 R12-8M | 102.50 | 652.00 |
| 12" x 10" Reducer* | 161 R12-10M | 160.00 | 580.06 |

*12" sockets come with a closing bar

| s-bends | part number | weight (lbs.) | list price |
|-------------------|-------------|---------------|------------|
| 4" Modular S Bend | 162 SBMA4 | 68.00 | 372.72 |
| 6" Modular S Bend | 162 SBMA6 | 81.00 | 637.68 |
| 8" Modular S Bend | 162 SBMA8 | 125.00 | 1,015.76 |

Wil-loc Reducers & Increasesers

vacuum 30 inches hg
 pressure rating 2 - 3" = 290 psi
 4 - 8" = 175 psi
 10 - 12" = 88 psi

| increaser specs. | A |
|---------------------|-------|
| 2" x 3" Increaser | 9.84 |
| 3" x 4" Increaser | 11.42 |
| 4" x 6" Increaser | 12.00 |
| 6" x 8" Increaser | 16.34 |
| 8" x 10" Increaser | 21.75 |
| 8" x 12" Increaser | 23.50 |
| 10" x 12" Increaser | 24.75 |

Specifications to 1/8th of an inch. Subject to change.

| reducer specs. | A |
|-------------------|-------|
| 3" x 2" Reducer | 9.25 |
| 4" x 3" Reducer | 11.23 |
| 6" x 2" Reducer | 9.84 |
| 6" x 3" Reducer | 11.02 |
| 6" x 4" Reducer | 12.00 |
| 8" x 2" Reducer | 13.00 |
| 8" x 3" Reducer | 13.00 |
| 8" x 4" Reducer | 17.32 |
| 8" x 6" Reducer | 16.54 |
| 10" x 8" Reducer | 22.50 |
| 12" x 8" Reducer | 23.00 |
| 12" x 10" Reducer | 24.00 |

Specifications to 1/8th of an inch. Subject to change.

| reducer specs. | A |
|----------------|-------|
| 4" S - Bends | 61.00 |
| 6" S - Bends | 70.00 |
| 8" S - Bends | 72.00 |

Specifications to 1/8th of an inch. Subject to change.

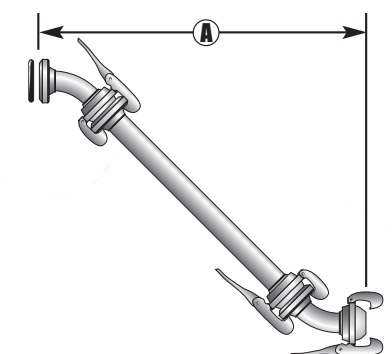
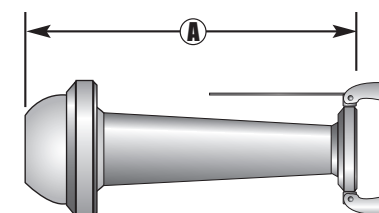
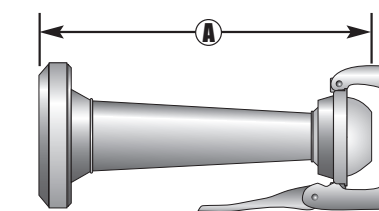
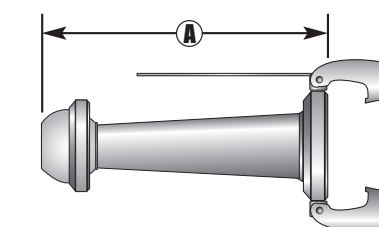
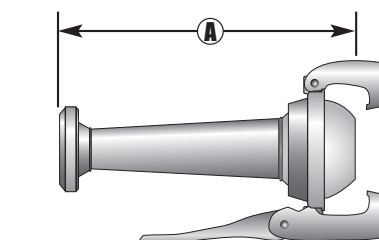

Tech Tip

Wil-loc Reducers and Increasesers are manufactured with a cone-shaped pipe, which allows for less flow restriction and smoother transition from one size to another.

Wil-loc modular S-Bends provide a smooth transition from a pump's discharge outlet to ground level. Combination of two 45-degree elbows & short pipe allows for maximum flexibility to accommodate unique jobsites and ground conditions.



| T's with male connection | part number | weight (lbs.) | list price |
|------------------------------|-------------|---------------|------------|
| 2" Tee Standard / M. Conn. | 060 T2M | 5.00 | 98.21 |
| 3" Tee Standard / M. Conn. | 060 T3M | 6.00 | 146.13 |
| 4" Tee Standard / M. Conn. | 060 T4M | 22.00 | 234.05 |
| 6" Tee Standard / M. Conn. | 060 T6M | 35.00 | 415.14 |
| 8" Tee Standard / M. Conn. | 060 T8M | 62.00 | 687.26 |
| 10" Tee Standard / M. Conn. | 061 T10M | 100.00 | 655.08 |
| 12" Tee Standard / M. Conn.* | 061 T12M | 135.00 | 1,223.05 |

*12" T's come with a closing bar.

| T's with female connection | part number | weight (lbs.) | list price |
|----------------------------|-------------|---------------|------------|
| 2" T Socket Connection | 050 T2F | 4.00 | 80.54 |
| 3" T Socket Connection | 050 T3F | 7.00 | 115.26 |
| 4" T Socket Connection | 050 T4F | 14.00 | 189.72 |
| 6" T Socket Connection | 050 T6F | 31.00 | 334.67 |
| 8" T Socket Connection | 050 T8F | 48.00 | 558.36 |
| 10" T Socket Connection | 054 T10F | 75.00 | 655.14 |
| 12" T Socket Connection* | 054 T12F | 125.00 | 1,268.18 |

*12" T's come with a closing bar.

| inline T's w/ male connect | part number | weight (lbs.) | list price |
|-----------------------------|-------------|---------------|------------|
| 2" Inline T/M. Connection | 051 LT2M | 4.00 | 80.54 |
| 3" Inline T/M. Connection | 051 LT3M | 7.00 | 115.26 |
| 4" Inline T/M. Connection | 051 LT4M | 14.00 | 189.72 |
| 6" Inline T/M. Connection | 051 LT6M | 30.00 | 334.67 |
| 8" Inline T/M. Connection | 051 LT8M | 43.00 | 558.36 |
| 10" Inline T/M. Connection | 052 LT10M | 75.00 | 655.14 |
| 12" Inline T/M. Connection* | 052 LT12M | 125.00 | 1,268.18 |

*12" T's come with a closing bar.

| double female Y's | part number | weight (lbs.) | list price |
|---------------------------|-------------|---------------|------------|
| 4" Y Double Female/Male | 064 YM4 | 14.00 | 193.44 |
| 6" Y Double Female/Male | 064 YM6 | 35.00 | 326.49 |
| 8" Y Double Female/Male | 064 YM8 | 49.00 | 754.03 |
| 10" Y Double Female/Male | 065 YM10 | 117.00 | 815.69 |
| 12" Y Double Female/Male* | 065 YM12 | 204.00 | 1,387.44 |

*12" Y sockets come with a closing bar.

| increasing Y's | part number | weight (lbs.) | list price |
|---------------------------------|-------------|---------------|------------|
| 2 - 4" x 6" Y Increaser Male | 066 YI4-6 | 43.00 | 321.02 |
| 2 - 6" x 8" Y Increaser Male | 066 YI6-8 | 66.00 | 408.09 |
| 2 - 8" x 10" Y Increaser Male | 067 YI8-10 | 79.00 | 836.09 |
| 2 - 8" x 12" Y Increaser Male* | 067 YI8-12 | 114.00 | 1,240.56 |
| 2 - 10" x 12" Y Increaser Male* | 067 YI10-12 | 165.00 | 1,336.06 |

*12" Y sockets come with a closing bar.

Wil-loc T's

vacuum 30 inches hg
 pressure rating 2 - 3" = 290 psi
 4 - 8" = 175 psi
 10 - 12" = 88 psi

| standard T specs. | A | B | C |
|---------------------|-------|-------|------|
| 2" T Standard Male | 14.02 | 7.09 | 2.36 |
| 3" T Standard Male | 16.14 | 9.25 | 2.76 |
| 4" T Standard Male | 20.32 | 11.42 | 2.76 |
| 6" T Standard Male | 22.63 | 12.00 | 3.15 |
| 8" T Standard Male | 27.68 | 13.00 | 3.94 |
| 10" T Standard Male | 33.50 | 17.75 | 6.00 |
| 12" T Standard Male | 37.50 | 20.50 | 6.00 |

Specifications to 1/8th of an inch. Subject to change.

| T socket specs. | A | B | C |
|-----------------|-------|-------|------|
| 2" T Socket | 14.02 | 4.13 | 2.36 |
| 3" T Socket | 16.14 | 4.53 | 2.76 |
| 4" T Socket | 30.32 | 5.71 | 2.76 |
| 6" T Socket | 22.63 | 7.09 | 3.15 |
| 8" T Socket | 27.68 | 9.25 | 3.94 |
| 10" T Socket | 33.25 | 15.50 | 6.00 |
| 12" T Socket | 37.50 | 17.25 | 6.00 |

Specifications to 1/8th of an inch. Subject to change.

| T male specs. | A | B | C |
|-------------------|-------|-------|------|
| 2" T Inline Male | 13.03 | 7.09 | 2.36 |
| 3" T Inline Male | 14.33 | 9.25 | 2.76 |
| 4" T Inline Male | 13.78 | 11.42 | 2.76 |
| 6" T Inline Male | 20.63 | 12.00 | 3.15 |
| 8" T Inline Male | 25.67 | 13.00 | 3.94 |
| 10" T Inline Male | 30.75 | 18.00 | 6.00 |
| 12" T Inline Male | 34.25 | 20.50 | 6.00 |

Specifications to 1/8th of an inch. Subject to change.

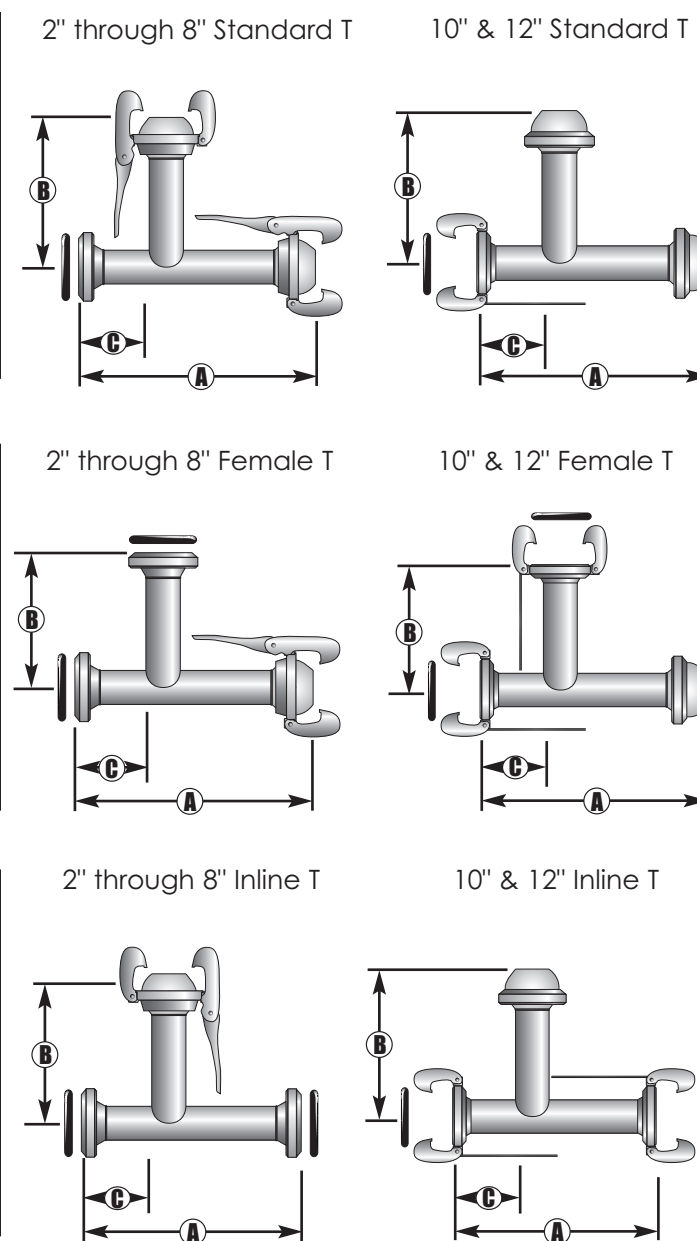

Tech Tip

When setting up a sewer by-pass pumping application, T or Y connections can be used to tie in a back-up pump's suction and discharge lines to the primary system.

Using two Wil-loc Flange Check Valve assemblies and one Y allows both the primary and the back-up pump in a by-pass application to be quickly and easily connected to a single discharge line.

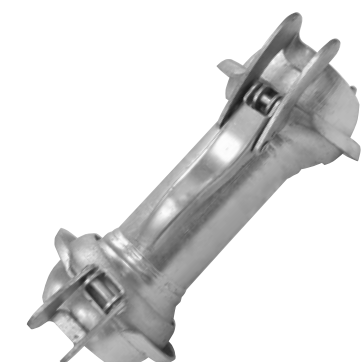

B-style double ball shown.



B-style double socket shown.

| end plugs | part number | weight (lbs.) | list price |
|-----------------------|-------------|---------------|------------|
| 2" End Plug Ball/Male | 090 EP2 | 1.35 | 24.73 |
| 3" End Plug Ball/Male | 090 EP3 | 2.35 | 39.62 |
| 4" End Plug Ball/Male | 090 EP4 | 4.45 | 50.09 |
| 6" End Plug Ball/Male | 090 EP6 | 8.90 | 88.60 |
| 8" End Plug Ball/Male | 090 EP8 | 11.65 | 121.15 |

| a-style end plugs | part number | weight (lbs.) | list price |
|------------------------|-------------|---------------|------------|
| 10" End Plug Ball/Male | 091 EP10 | 25.00 | 106.03 |
| 12" End Plug Ball/Male | 091 EP12 | 44.00 | 253.95 |

| end caps | part number | weight (lbs.) | list price |
|--------------------------|-------------|---------------|------------|
| 2" End Cap Socket/Female | 100 EC2 | 0.40 | 8.37 |
| 3" End Cap Socket/Female | 100 EC3 | 0.80 | 9.24 |
| 4" End Cap Socket/Female | 100 EC4 | 1.95 | 19.10 |
| 6" End Cap Socket/Female | 100 EC6 | 3.90 | 37.57 |
| 8" End Cap Socket/Female | 100 EC8 | 7.80 | 75.51 |

| a-style end caps | part number | weight (lbs.) | list price |
|---------------------------|-------------|---------------|------------|
| 10" End Cap Socket/Female | 101 EC10 | 16.00 | 132.43 |
| 12" End Cap Socket/Female | 101 EC12 | 36.00 | 264.94 |

*12" end caps come with a closing bar

| double balls | part number | weight (lbs.) | list price |
|----------------------|-------------|---------------|------------|
| 2" Double Ball/Male | 110 DB2 | 5.00 | 53.69 |
| 3" Double Ball/Male | 110 DB3 | 6.80 | 85.43 |
| 4" Double Ball/Male | 110 DB4 | 13.50 | 147.48 |
| 6" Double Ball/Male | 110 DB6 | 26.45 | 265.04 |
| 8" Double Ball/Male | 110 DB8 | 41.15 | 466.97 |
| 10" Double Ball/Male | 111 DB10 | 54.00 | 354.08 |
| 12" Double Ball/Male | 111 DB12 | 96.00 | 627.43 |

| double sockets | part number | weight (lbs.) | list price |
|--------------------------|-------------|---------------|------------|
| 2" Double Socket/Female | 120 DS2 | 0.90 | 19.46 |
| 3" Double Socket/Female | 120 DS3 | 2.00 | 28.95 |
| 4" Double Socket/Female | 120 DS4 | 4.50 | 54.68 |
| 6" Double Socket/Female | 120 DS6 | 5.00 | 97.34 |
| 8" Double Socket/Female | 120 DS8 | 13.65 | 186.62 |
| 10" Double Socket/Female | 121 DS10 | 42.00 | 388.92 |
| 12" Double Socket/Female | 121 DS12 | 87.00 | 750.99 |

*12" end caps come with a closing bar

| end plug specs. | A |
|------------------------|------|
| 2" End Plug Ball/Male | 2.17 |
| 3" End Plug Ball/Male | 2.87 |
| 4" End Plug Ball/Male | 4.21 |
| 6" End Plug Ball/Male | 4.06 |
| 8" End Plug Ball/Male | 5.00 |
| 10" End Plug Ball/Male | 6.73 |
| 12" End Plug Ball/Male | 8.35 |

Specifications to 1/8th of an inch. Subject to change.

| end cap specs. | A |
|---------------------------|-------|
| 2" End Cap Socket Female | 3.27 |
| 3" End Cap Socket Female | 4.57 |
| 4" End Cap Socket Female | 6.50 |
| 6" End Cap Socket Female | 8.31 |
| 8" End Cap Socket Female | 10.51 |
| 10" End Cap Socket Female | 9.72 |
| 12" End Cap Socket Female | 12.20 |

Specifications to 1/8th of an inch. Subject to change.

| double ball specs. | A |
|---------------------|-------|
| 2" Double Ball/Male | 10.04 |
| 3" Double Ball/Male | 11.42 |
| 4" Double Ball/Male | 16.73 |
| 6" Double Ball/Male | 15.75 |
| 8" Double Ball/Male | 18.11 |

Specifications to 1/8th of an inch. Subject to change.

| double socket specs. | A |
|-------------------------|-------|
| 2" Double Socket/Female | 4.72 |
| 3" Double Socket/Female | 4.92 |
| 4" Double Socket/Female | 6.50 |
| 6" Double Socket/Female | 7.09 |
| 8" Double Socket/Female | 10.24 |

Specifications to 1/8th of an inch. Subject to change.

Tech Tip

End caps and plugs may be used for several purposes, such as closing off the end of a pipeline, capping unused branches on T's and Y's, vacuum/pressure testing of pumps or pipe, or capping pump fittings during transport.

For easier coupling (especially of larger sizes) lubricate new Wil-loc O-rings. This will allow the ball to seat into the socket easier during first time usage.

2" through 8" End Plug

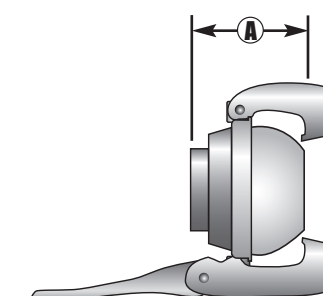

10" & 12" End Plug

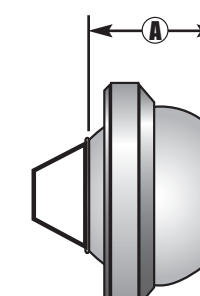

2" through 8" End Cap

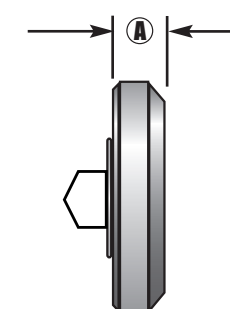

10" & 12" End Cap

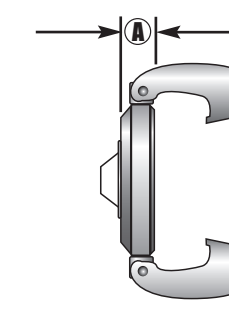

Double Ball/Male

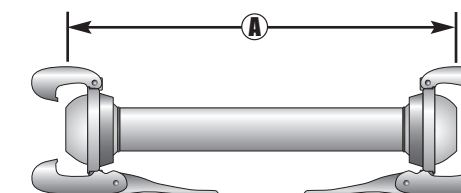

Double Socket/Female

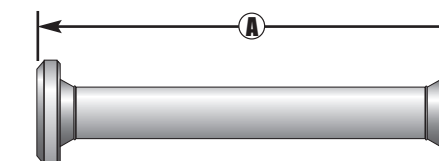

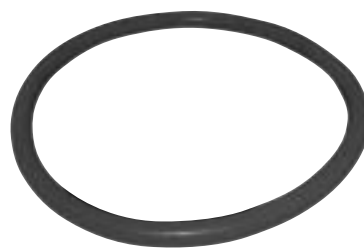

| steel weld-on sets | part number | weight (lbs.) | list price |
|-------------------------------|-------------|---------------|------------|
| 2" Black Ball/Skt Weld-On Set | 240 BWA2 | 1.75 | 22.00 |
| 3" Black Ball/Skt Weld-On Set | 240 BWA3 | 3.75 | 31.88 |
| 4" Black Ball/Skt Weld-On Set | 240 BWA4 | 6.05 | 54.64 |
| 5" Black Ball/Skt Weld-On Set | 240 BWA5 | 8.75 | 78.96 |
| 6" Black Ball/Skt Weld-On Set | 240 BWA6 | 13.68 | 101.12 |
| 8" Black Ball/Skt Weld-On Set | 240 BWA8 | 24.00 | 189.24 |

| steel weld-on balls | part number | weight (lbs.) | list price |
|---------------------|-------------|---------------|------------|
| 2" Ball/Male Black | 255 B2B | 0.50 | 3.76 |
| 3" Ball/Male Black | 255 B3B | 0.70 | 5.11 |
| 4" Ball/Male Black | 255 B4B | 1.05 | 10.86 |
| 5" Ball/Male Black | 255 B5B | 2.00 | 13.51 |
| 6" Ball/Male Black | 255 B6B | 2.75 | 16.60 |
| 8" Ball/Male Black | 255 B8B | 4.75 | 33.21 |

| steel weld-on sockets | part number | weight (lbs.) | list price |
|------------------------|-------------|---------------|------------|
| 2" Socket/Female Black | 257 S2B | 0.40 | 5.05 |
| 3" Socket/Female Black | 257 S3B | 0.80 | 6.88 |
| 4" Socket/Female Black | 257 S4B | 1.00 | 13.07 |
| 5" Socket/Female Black | 257 S5B | 2.00 | 21.53 |
| 6" Socket/Female Black | 257 S6B | 2.95 | 26.39 |
| 8" Socket/Female Black | 257 S8B | 4.03 | 51.07 |

| steel weld-on levers | part number | weight (lbs.) | list price |
|-----------------------------|-------------|---------------|------------|
| 2" Lever Locking Ring Black | 274 LR2B | 0.98 | 13.21 |
| 3" Lever Locking Ring Black | 274 LR3B | 1.88 | 19.89 |
| 4" Lever Locking Ring Black | 274 LR4B | 4.70 | 30.71 |
| 5" Lever Locking Ring Black | 274 LR5B | 6.00 | 41.90 |
| 6" Lever Locking Ring Black | 274 LR6B | 9.00 | 58.11 |
| 8" Lever Locking Ring Black | 274 LR8B | 13.00 | 104.96 |

| oil resistant o-rings | part number | weight (lbs.) | list price |
|-------------------------|-------------|---------------|------------|
| 2" Oil Resistant O-Ring | 285 OR2R | 0.05 | 3.25 |
| 3" Oil Resistant O-Ring | 285 OR3R | 0.10 | 4.25 |
| 4" Oil Resistant O-Ring | 285 OR4R | 0.20 | 7.20 |
| 6" Oil Resistant O-Ring | 285 OR6R | 0.50 | 12.50 |
| 8" Oil Resistant O-Ring | 285 OR8R | 0.55 | 22.00 |

Wil-loc B-Style Carbon Steel Weld-Ons

vacuum rating 30 inches hg
psi rating 2 & 3 inch = 290
4 - 8 inch = 175

| weld-on set specs. | A | B | C | D | E |
|--------------------|------|-------|-------|------|-------|
| 2" Weld-On Set | 2.68 | 6.10 | 7.09 | 3.35 | 4.92 |
| 3" Weld-On Set | 3.43 | 7.87 | 9.25 | 3.54 | 7.09 |
| 4" Weld-On Set | 5.28 | 11.81 | 10.83 | 6.69 | 9.25 |
| 5" Weld-On Set | 4.69 | 11.22 | 11.42 | 5.51 | 10.83 |
| 6" Weld-On Set | 4.84 | 12.60 | 13.39 | 6.30 | 11.81 |
| 8" Weld-On Set | 6.30 | 15.35 | 13.19 | 9.06 | 13.98 |

Specifications to 1/100th of an inch • Specifications Subject to Change

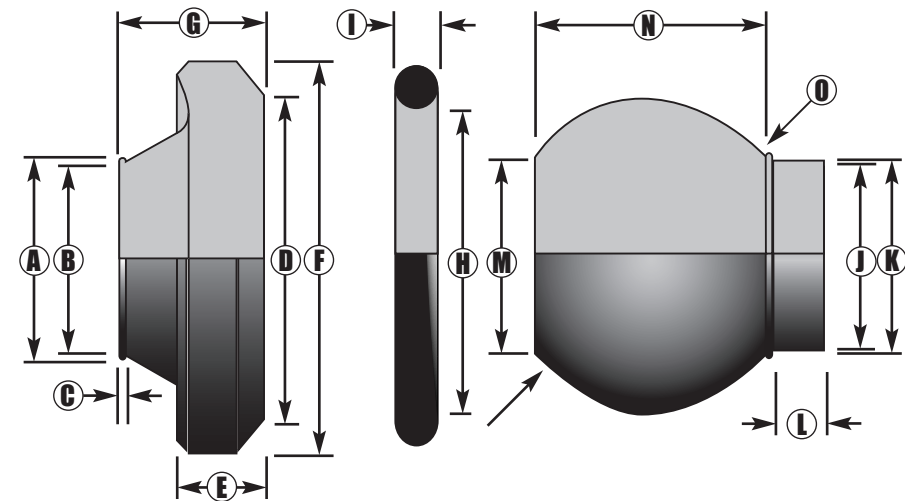
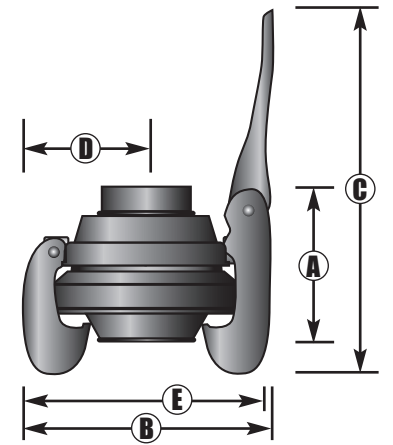

| specs. | A | B | C | D | E | F | G | H | I | J | K | L | M | N | O |
|------------|------|------|------|------|------|-------|------|------|------|------|------|------|------|------|------|
| 2" Weld-On | 2.01 | 1.91 | 0.24 | 2.83 | 0.67 | 3.27 | 1.22 | 2.44 | 0.37 | 1.91 | 2.01 | 0.28 | 1.97 | 2.17 | 2.76 |
| 3" Weld-On | 3.07 | 2.99 | 0.28 | 3.86 | 0.87 | 4.57 | 1.46 | 3.48 | 0.51 | 2.99 | 3.07 | 0.55 | 3.19 | 2.87 | 3.86 |
| 4" Weld-On | 4.37 | 4.25 | 0.47 | 5.79 | 1.10 | 6.50 | 2.32 | 5.20 | 0.59 | 4.25 | 4.37 | 0.59 | 4.41 | 4.21 | 5.71 |
| 5" Weld-On | 5.39 | 5.20 | 0.47 | 6.42 | 1.34 | 7.52 | 2.13 | 5.98 | 0.71 | 5.20 | 5.39 | 0.67 | 5.39 | 3.78 | 6.26 |
| 6" Weld-On | 6.42 | 6.22 | 0.59 | 7.17 | 1.34 | 8.31 | 2.05 | 6.69 | 0.75 | 6.22 | 6.42 | 0.75 | 6.10 | 4.06 | 7.09 |
| 8" Weld-On | 7.95 | 7.64 | 0.71 | 9.09 | 1.34 | 10.51 | 2.99 | 8.66 | 0.75 | 7.64 | 7.87 | 0.67 | 7.87 | 5.00 | 9.06 |

Specifications to 1/100th of an inch • Specifications Subject to Change

Tech Tip

Virtually any plumbing configuration may be fabricated using the Wil-loc Carbon Steel Weld-On Fittings. Please check columns A & K for correct pipe sizing. IPSO and ODA pipe may be used with steel weld-on fittings.

When fabricating customized fittings, ensure there is enough length for the locking levers to fully close without restriction. The minimum shank lengths are given on the flange specifications pages of this catalog.



| weld-on set | part number | weight (lbs.) | list price |
|-----------------|-------------|---------------|------------|
| 10" Weld-On Set | 241 BWA10 | 32.20 | 158.80 |



| weld-on set | part number | weight (lbs.) | list price |
|-----------------------------------|-------------|---------------|------------|
| 12" Weld-On Set | 241 BWA12 | 61.00 | 324.16 |
| *12" set comes with a closing bar | | | |



| weld-on socket | part number | weight (lbs.) | list price |
|-------------------------|-------------|---------------|------------|
| 10" Black Socket/Female | 258 S10B | 14.55 | 80.11 |



| weld-on socket | part number | weight (lbs.) | list price |
|-----------------------------------|-------------|---------------|------------|
| 12" Black Socket/Female | 258 S12B | 28.75 | 185.15 |
| *12" set comes with a closing bar | | | |



| weld-on balls | part number | weight (lbs.) | list price |
|---------------------|-------------|---------------|------------|
| 10" Black Ball/Male | 256 B10B | 9.75 | 42.74 |
| 12" Black Ball/Male | 256 B12B | 17.00 | 77.14 |



| weld-on locking ring | part number | weight (lbs.) | list price |
|------------------------|-------------|---------------|------------|
| 10" Black Locking Ring | 259 B10R | 7.90 | 35.97 |
| 12" Black Locking Ring | 259 B12R | 12.75 | 61.84 |



| oil resistant o-rings | part number | weight (lbs.) | list price |
|---------------------------|-------------|---------------|------------|
| 10" Oil Resistant O-Rings | 286 OR10R | 1.05 | 31.00 |
| 12" Oil Resistant O-Rings | 286 OR12R | 1.55 | 35.00 |

Wil-loc A-Style Carbon Steel Weld-Ons

vacuum rating 30 inches hg

pressure rating 88 psi

Note: 12" locking rings come with a removable locking bar

| weld-on set specs. | A | B | C |
|---------------------------------------|-------|-------|-------|
| 10" Weld-On Set | 9.06 | 20.08 | 15.35 |
| 12" Weld-On Set | 10.24 | 24.21 | 10.43 |
| Specifications to 1/100th of an inch. | | | |

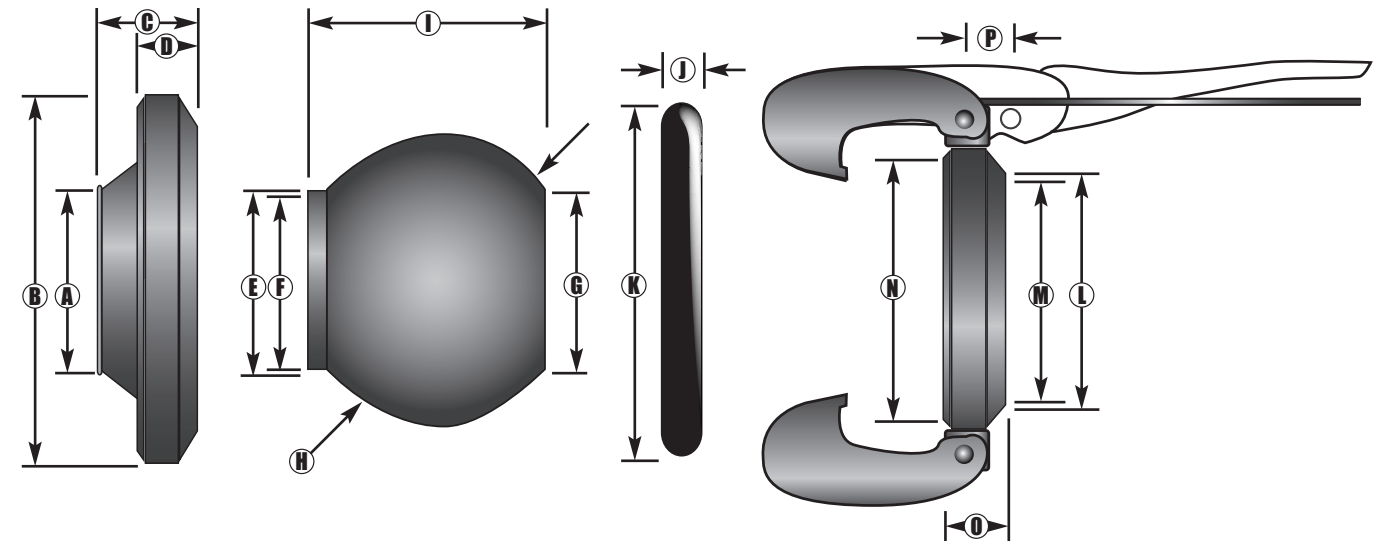
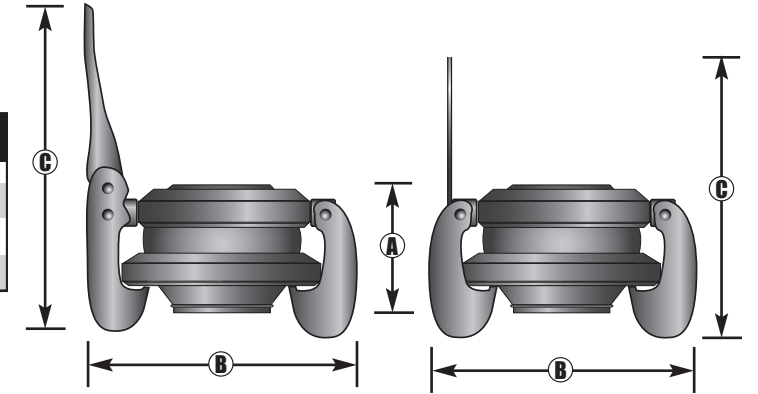

| specs. | A | B | C | D | E | F | G | H | I | J | K | L | M | N | O | P |
|--------------------------------------------------------------------------|-------|-------|------|------|-------|-------|-------|-------|------|------|-------|-------|-------|-------|------|------|
| 10" Weld-On | 11.14 | 14.09 | 2.40 | 1.42 | 9.57 | 9.25 | 9.96 | 11.81 | 6.73 | 0.86 | 11.06 | 9.72 | 9.37 | 11.89 | 4.33 | 1.38 |
| 12" Weld-On | 13.35 | 17.56 | 2.76 | 1.69 | 12.01 | 11.65 | 11.97 | 14.57 | 8.35 | 0.93 | 13.98 | 12.20 | 11.85 | 14.65 | 4.92 | 1.65 |
| Specifications to 1/100th of an inch • Specifications Subject to Change. | | | | | | | | | | | | | | | | |

Tech Tip

For applications that prohibit use of hot-dipped galvanized pipe and fittings, Wil-loc Black Weld-Ons and O-Rings may be specially plated or coated to fit your needs. Epoxy-painted, zinc-plated and fused-Teflon coatings are available.

Before welding, check to make sure locking ring can slide over the O.D. of your pipe. If not, place locking ring over the pipe and weld the male fitting onto the end of the pipe.



| complete weld-on sets | part number | weight (lbs.) | list price |
|-------------------------|-------------|---------------|------------|
| 2" Aluminum Weld-On Set | 732 AWA2 | 1.60 | 49.36 |
| 3" Aluminum Weld-On Set | 732 AWA3 | 3.55 | 87.84 |
| 4" Aluminum Weld-On Set | 732 AWA4 | 7.00 | 104.76 |
| 5" Aluminum Weld-On Set | 732 AWA5 | 12.00 | 143.96 |
| 6" Aluminum Weld-On Set | 732 AWA6 | 14.00 | 178.92 |
| 8" Aluminum Weld-On Set | 732 AWA8 | 20.50 | 303.64 |



| weld-on balls | part number | weight (lbs.) | list price |
|------------------|-------------|---------------|------------|
| 2" Aluminum Ball | 732 BA2 | 0.25 | 16.65 |
| 3" Aluminum Ball | 732 BA3 | 0.50 | 22.43 |
| 4" Aluminum Ball | 732 BA4 | 1.15 | 30.35 |
| 5" Aluminum Ball | 732 BA5 | 4.00 | 39.52 |
| 6" Aluminum Ball | 732 BA6 | 2.15 | 46.56 |
| 8" Aluminum Ball | 732 BA8 | 3.40 | 74.33 |



| weld-on sockets | part number | weight (lbs.) | list price |
|---------------------|-------------|---------------|------------|
| 2" Aluminum Sockets | 734 AA2 | 0.35 | 17.03 |
| 3" Aluminum Sockets | 734 AA3 | 0.70 | 23.88 |
| 4" Aluminum Sockets | 734 AA4 | 1.40 | 32.86 |
| 5" Aluminum Sockets | 734 AA5 | 2.00 | 44.55 |
| 6" Aluminum Sockets | 734 AA6 | 2.55 | 51.71 |
| 8" Aluminum Sockets | 734 AA8 | 4.15 | 91.29 |

Wil-loc Cast Aluminum Weld-Ons

vacuum rating 30 inches hg
psi rating 2 & 3 inch = 290
4 - 8 inch = 175

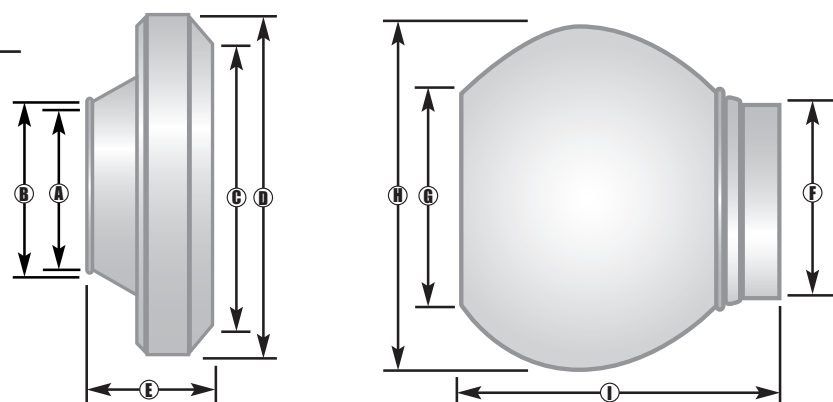

| male mechanical specs. | A | B | C | D | E | F | G | H | I |
|------------------------|------|------|------|-------|------|------|------|------|------|
| 2" Aluminum Weld-On | 2.01 | 2.28 | 2.80 | 3.54 | 1.42 | 2.36 | 1.89 | 2.80 | 2.32 |
| 3" Aluminum Weld-On | 3.01 | 3.35 | 3.88 | 4.88 | 1.65 | 3.39 | 2.99 | 3.86 | 3.15 |
| 4" Aluminum Weld-On | 4.02 | 4.41 | 5.67 | 6.69 | 2.20 | 4.37 | 4.21 | 5.67 | 4.41 |
| 5" Aluminum Weld-On | 5.04 | 5.35 | 5.98 | 7.72 | 2.36 | 5.31 | 4.88 | 6.26 | 5.20 |
| 6" Aluminum Weld-On | 6.04 | 6.42 | 7.13 | 8.50 | 2.44 | 6.38 | 5.55 | 7.09 | 5.39 |
| 8" Aluminum Weld-On | 8.01 | 8.86 | 9.13 | 10.71 | 3.27 | 8.39 | 7.72 | 9.06 | 6.46 |

Hose Set Specifications to 1/100th of an inch • Specifications Subject to Change



| complete hose sets (al) | part number | weight (lbs.) | list price |
|-------------------------|-------------|---------------|------------|
| 2" Hose Set Assembly | 775 HSAA2 | 2.75 | 121.50 |
| 3" Hose Set Assembly | 775 HSAA3 | 6.35 | 138.08 |
| 4" Hose Set Assembly | 775 HSAA4 | 10.45 | 190.99 |
| 6" Hose Set Assembly | 775 HSAA6 | 22.40 | 300.46 |
| 8" Hose Set Assembly | 775 HSAA8 | 33.55 | 487.11 |

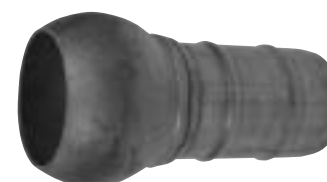

| male hose ends (al) | part number | weight (lbs.) | list price |
|------------------------|-------------|---------------|------------|
| 2" Hose Tail Ball/Male | 760 HTMA2 | 0.75 | 51.36 |
| 3" Hose Tail Ball/Male | 760 HTMA3 | 1.75 | 53.18 |
| 4" Hose Tail Ball/Male | 760 HTMA4 | 3.00 | 69.69 |
| 6" Hose Tail Ball/Male | 760 HTMA6 | 6.15 | 99.98 |
| 8" Hose Tail Ball/Male | 760 HTMA8 | 9.40 | 162.46 |



| female hose ends (al) | part number | weight (lbs.) | list price |
|----------------------------|-------------|---------------|------------|
| 2" Hose Tail Socket/Female | 770 HTFA2 | 1.00 | 52.06 |
| 3" Hose Tail Socket/Female | 770 HTFA3 | 2.25 | 55.37 |
| 4" Hose Tail Socket/Female | 770 HTFA4 | 3.00 | 73.54 |
| 6" Hose Tail Socket/Female | 770 HTFA6 | 7.00 | 107.70 |
| 8" Hose Tail Socket/Female | 770 HTFA8 | 11.15 | 165.89 |



| locking levers galvanized | part number | weight (lbs.) | list price |
|---------------------------|-------------|---------------|------------|
| 2" Lever Locking Ring | 273 LR2 | 1.05 | 15.72 |
| 3" Lever Locking Ring | 273 LR3 | 2.35 | 25.69 |
| 4" Lever Locking Ring | 273 LR4 | 4.45 | 41.53 |
| 6" Lever Locking Ring | 273 LR6 | 9.25 | 80.68 |
| 8" Lever Locking Ring | 273 LR8 | 13.00 | 138.05 |

Tech Tip

Wil-loc Aluminum fittings are completely interchangeable with Wil-loc Galvanized steel or Stainless steel fittings. For certain applications, where weight is a concern, aluminum fittings may be the best solution.

Wil-loc Aluminum Weld-Ons are manufactured using a mold cast aluminum process, producing a high quality, consistent part that welds quickly and easily to aluminum pipe or components.

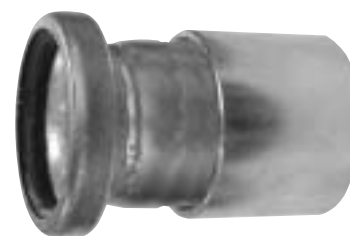

| discharge flanges (al) | part number | weight (lbs.) | list price |
|------------------------|-------------|---------------|------------|
| 3" Flange Ball/Male | 710 FA3M | 8.85 | 170.09 |
| 4" Flange Ball/Male | 710 FA4M | 15.60 | 210.25 |
| 6" Flange Ball/Male | 710 FA6M | 29.75 | 320.62 |
| 8" Flange Ball/Male | 710 FA8M | 41.40 | 478.00 |

All flanges are designed to meet ASA specifications

| suction flanges (al) | part number | weight (lbs.) | list price |
|-------------------------|-------------|---------------|------------|
| 3" Flange Socket/Female | 730 FA3F | 4.70 | 132.35 |
| 4" Flange Socket/Female | 730 FA4F | 9.40 | 149.57 |
| 6" Flange Socket/Female | 730 FA6F | 13.55 | 202.88 |
| 8" Flange Socket/Female | 730 FA8F | 19.15 | 288.96 |

All flanges are designed to meet ASA specifications

| male threaded long balls (al) | part number | weight (lbs.) | list price |
|-------------------------------|-------------|---------------|------------|
| 2" Male Thrd/Long/Ball | 720 BMTA2 | 4.50 | 85.68 |
| 3" Male Thrd/Long/Ball | 720 BMTA3 | 8.85 | 129.59 |
| 4" Male Thrd/Long/Ball | 720 BMTA4 | 17.60 | 174.78 |
| 6" Male Thrd/Long/Ball | 720 BMTA6 | 31.75 | 312.46 |
| 8" Male Thrd/Long/Ball | 720 BMTA8 | 45.40 | 506.22 |

All threads are cut to NPT specifications

| female threaded balls (al) | part number | weight (lbs.) | list price |
|----------------------------|-------------|---------------|------------|
| 2" Female Thrd/Ball/Male | 725 BFTA2 | 2.90 | 100.73 |
| 3" Female Thrd/Ball/Male | 725 BFTA3 | 5.05 | 159.83 |
| 4" Female Thrd/Ball/Male | 725 BFTA4 | 8.85 | 249.21 |
| 6" Female Thrd/Ball/Male | 725 BFTA6 | 16.00 | 666.47 |

All threads are cut to NPT specifications

| male threaded sockets (al) | part number | weight (lbs.) | list price |
|----------------------------|-------------|---------------|------------|
| 2" Male Thrd/Socket/Female | 740 SMTA2 | 4.50 | 53.13 |
| 3" Male Thrd/Socket/Female | 740 SMTA3 | 5.70 | 83.02 |
| 4" Male Thrd/Socket/Female | 740 SMTA4 | 6.40 | 104.50 |
| 6" Male Thrd/Socket/Female | 740 SMTA6 | 13.55 | 177.61 |
| 8" Male Thrd/Socket/Female | 740 SMTA8 | 21.15 | 297.08 |

All threads are cut to NPT specifications

| female threaded sockets (al) | part number | weight (lbs.) | list price |
|------------------------------|-------------|---------------|------------|
| 2" Female Thrd/Skt/Female | 745 SFTA2 | 1.85 | 48.13 |
| 3" Female Thrd/Skt/Female | 745 SFTA3 | 2.70 | 69.46 |
| 4" Female Thrd/Skt/Female | 745 SFTA4 | 4.40 | 103.75 |
| 6" Female Thrd/Skt/Female | 745 SFTA6 | 6.75 | 182.53 |

All threads are cut to NPT specifications



| 90° elbow (al) | part number | weight (lbs.) | list price |
|--------------------|-------------|---------------|------------|
| 2" 90 Degree Elbow | 770 EA2-90 | 5.00 | 135.34 |
| 3" 90 Degree Elbow | 770 EA3-90 | 8.55 | 171.83 |
| 4" 90 Degree Elbow | 770 EA4-90 | 16.00 | 226.30 |
| 6" 90 Degree Elbow | 770 EA6-90 | 32.00 | 378.57 |
| 8" 90 Degree Elbow | 770 EA8-90 | 47.50 | 585.29 |

| 45° elbow (al) | part number | weight (lbs.) | list price |
|--------------------|-------------|---------------|------------|
| 2" 45 Degree Elbow | 780 EA2-45 | 5.00 | 113.69 |
| 3" 45 Degree Elbow | 780 EA3-45 | 8.55 | 149.57 |
| 4" 45 Degree Elbow | 780 EA4-45 | 15.00 | 200.54 |
| 6" 45 Degree Elbow | 780 EA6-45 | 30.00 | 341.30 |
| 8" 45 Degree Elbow | 780 EA8-45 | 44.50 | 542.66 |

| increasers (al) | part number | weight (lbs.) | list price |
|-------------------|-------------|---------------|------------|
| 2" x 3" Increaser | 750 INA2-3M | 7.70 | 137.41 |
| 3" x 4" Increaser | 750 INA3-4M | 14.30 | 187.86 |
| 4" x 6" Increaser | 750 INA4-6M | 27.30 | 293.96 |
| 6" x 8" Increaser | 750 INA6-8M | 42.00 | 385.47 |

| reducers (al) | part number | weight (lbs.) | list price |
|-----------------|-------------|---------------|------------|
| 3" x 2" Reducer | 760 RA3-2M | 5.00 | 123.37 |
| 4" x 3" Reducer | 760 RA4-3M | 10.25 | 164.90 |
| 6" x 4" Reducer | 760 RA6-4M | 16.50 | 236.93 |
| 8" x 6" Reducer | 760 RA8-6M | 34.50 | 392.15 |

Tech Tip

Certain chemicals may cause extensive acceleration of aluminum corrosion. It is important to check chemical compatibility charts before using aluminum fittings or pipe in certain applications.

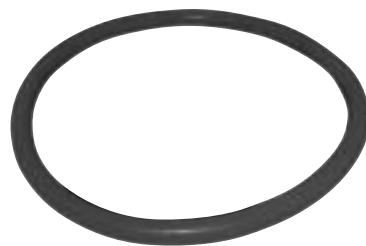

| stainless steel weld-on sets | part number | weight (lbs.) | list price |
|------------------------------|-------------|---------------|------------|
| 2" Stainless Weld-On Set | 840 BWAS2 | 1.95 | 90.68 |
| 3" Stainless Weld-On Set | 840 BWAS3 | 3.85 | 154.28 |
| 4" Stainless Weld-On Set | 840 BWAS4 | 6.70 | 273.32 |
| 6" Stainless Weld-On Set | 840 BWAS6 | 14.95 | 423.12 |
| 8" Stainless Weld-On Set | 840 BWAS8 | 21.78 | 635.24 |

Call for minimum quantities & delivery times

| stainless steel weld-on balls | part number | weight (lbs.) | list price |
|-------------------------------|-------------|---------------|------------|
| 2" Ball/Male Stainless Steel | 855 BS2 | 0.50 | 34.47 |
| 3" Ball/Male Stainless Steel | 855 BS3 | 0.70 | 55.11 |
| 4" Ball/Male Stainless Steel | 855 BS4 | 1.05 | 107.63 |
| 6" Ball/Male Stainless Steel | 855 BS6 | 2.75 | 139.58 |
| 8" Ball/Male Stainless Steel | 855 BS8 | 4.75 | 216.85 |

Call for minimum quantities & delivery times

| stainless steel weld-on sockets | part number | weight (lbs.) | list price |
|---------------------------------|-------------|---------------|------------|
| 2" Skt/Female Stainless Steel | 857 SS2 | 0.40 | 40.53 |
| 3" Skt/Female Stainless Steel | 857 SS3 | 0.80 | 73.48 |
| 4" Skt/Female Stainless Steel | 857 SS4 | 1.20 | 124.17 |
| 6" Skt/Female Stainless Steel | 857 SS6 | 2.95 | 202.89 |
| 8" Skt/Female Stainless Steel | 857 SS8 | 4.03 | 280.37 |

Call for minimum quantities & delivery times

| galvanized locking levers | part number | weight (lbs.) | list price |
|---------------------------|-------------|---------------|------------|
| 2" Lever Locking Ring | 273 LR2 | 1.05 | 15.72 |
| 3" Lever Locking Ring | 273 LR3 | 2.35 | 25.69 |
| 4" Lever Locking Ring | 273 LR4 | 4.45 | 41.53 |
| 6" Lever Locking Ring | 273 LR6 | 9.25 | 80.68 |
| 8" Lever Locking Ring | 273 LR8 | 13.00 | 138.05 |

| viton™ o-rings | part number | weight (lbs.) | list price |
|-----------------|-------------|---------------|------------|
| 2" Viton O-Ring | 880 VOR2 | | call |
| 3" Viton O-Ring | 880 VOR3 | | call |
| 4" Viton O-Ring | 880 VOR4 | | call |
| 6" Viton O-Ring | 880 VOR6 | | call |
| 8" Viton O-Ring | 880 VOR8 | | call |

Wil-loc Stainless Steel Weld-Ons

vacuum rating 30 inches hg metallurgy 304: standard
psi rating 2 & 3 inch = 290 316: optional
4 - 8 inch = 175

| weld-on set specs. | A | B | C |
|--------------------|------|-------|-------|
| 2" Weld-On Set | 2.68 | 6.10 | 7.09 |
| 3" Weld-On Set | 3.43 | 7.87 | 9.25 |
| 4" Weld-On Set | 5.28 | 11.81 | 10.83 |
| 5" Weld-On Set | 4.69 | 11.22 | 11.42 |
| 6" Weld-On Set | 4.84 | 12.60 | 13.39 |
| 8" Weld-On Set | 6.30 | 15.35 | 13.19 |

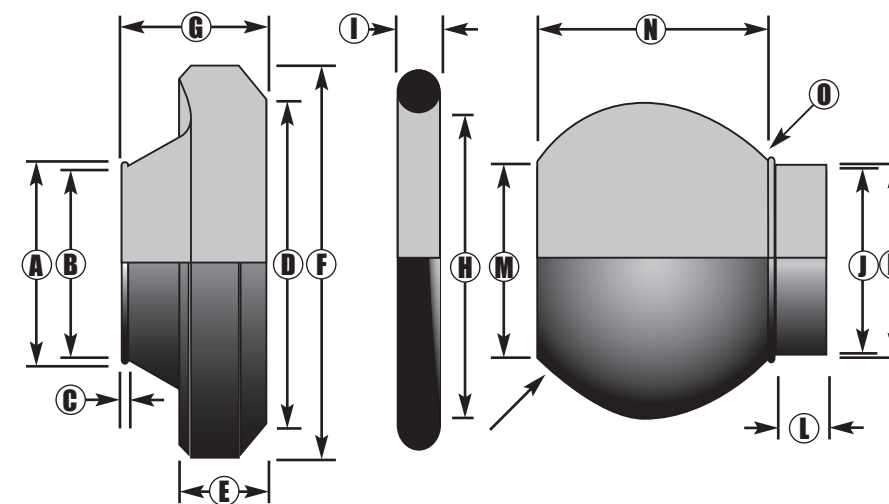
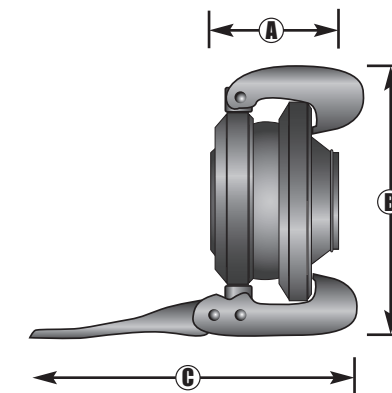

| specs. | A | B | C | D | E | F | G | H | I | J | K | L | M | N | O |
|------------|------|------|------|------|------|-------|------|------|------|------|------|------|------|------|------|
| 2" Weld-On | 2.01 | 1.91 | 0.24 | 2.83 | 0.67 | 3.27 | 1.22 | 2.44 | 0.37 | 1.91 | 2.01 | 0.28 | 1.97 | 2.17 | 2.76 |
| 3" Weld-On | 3.07 | 2.99 | 0.28 | 3.86 | 0.87 | 4.57 | 1.46 | 3.48 | 0.51 | 2.99 | 3.07 | 0.55 | 3.19 | 2.87 | 3.86 |
| 4" Weld-On | 4.37 | 4.25 | 0.47 | 5.79 | 1.10 | 6.50 | 2.32 | 5.20 | 0.59 | 4.25 | 4.37 | 0.59 | 4.41 | 4.21 | 5.71 |
| 5" Weld-On | 5.39 | 5.20 | 0.47 | 6.42 | 1.34 | 7.52 | 2.13 | 5.98 | 0.71 | 5.20 | 5.39 | 0.67 | 5.39 | 3.78 | 6.26 |
| 6" Weld-On | 6.42 | 6.22 | 0.59 | 7.17 | 1.34 | 8.31 | 2.05 | 6.69 | 0.75 | 6.22 | 6.42 | 0.75 | 6.10 | 4.06 | 7.09 |
| 8" Weld-On | 7.95 | 7.64 | 0.71 | 9.09 | 1.34 | 10.51 | 2.99 | 8.66 | 0.75 | 7.64 | 7.87 | 0.67 | 7.87 | 5.00 | 9.06 |

Specifications to 1/100th of an inch • Specifications Subject to Change

Tech Tip

Virtually any plumbing configuration may be fabricated using the Wil-loc Stainless Steel Weld-On fittings. Please check columns A & K for correct pipe sizing. IPSO and ODA pipe may be used with stainless steel weld-on fittings.

When fabricating customized fittings, ensure there is enough length for the locking levers to fully close without restriction. The minimum shank lengths are given on the flange specifications pages of this catalog.



| complete hose sets (ss) | part number | weight (lbs.) | list price |
|-------------------------|-------------|---------------|------------|
| 2" Hose Set Assembly | 875 HSAS2 | 2.45 | 180.04 |
| 3" Hose Set Assembly | 875 HSAS3 | 5.30 | 272.37 |
| 4" Hose Set Assembly | 875 HSAS4 | 10.45 | 519.43 |
| 6" Hose Set Assembly | 875 HSAS6 | 21.70 | 694.00 |
| 8" Hose Set Assembly | 875 HSAS8 | 35.70 | 1,192.50 |



| male hose ends (ss) | part number | weight (lbs.) | list price |
|------------------------|-------------|---------------|------------|
| 2" Hose Tail Ball/Male | 860 HTMS2 | 0.65 | 77.37 |
| 3" Hose Tail Ball/Male | 860 HTMS3 | 1.45 | 110.86 |
| 4" Hose Tail Ball/Male | 860 HTMS4 | 3.10 | 212.58 |
| 6" Hose Tail Ball/Male | 860 HTMS6 | 5.85 | 253.51 |
| 8" Hose Tail Ball/Male | 860 HTMS8 | 10.70 | 476.58 |



| female hose ends (ss) | part number | weight (lbs.) | list price |
|----------------------------|-------------|---------------|------------|
| 2" Hose Tail Socket/Female | 870 HTFS2 | 0.75 | 84.62 |
| 3" Hose Tail Socket/Female | 870 HTFS3 | 1.50 | 131.96 |
| 4" Hose Tail Socket/Female | 870 HTFS4 | 2.90 | 259.14 |
| 6" Hose Tail Socket/Female | 870 HTFS6 | 6.60 | 347.70 |
| 8" Hose Tail Socket/Female | 870 HTFS8 | 12.00 | 558.30 |

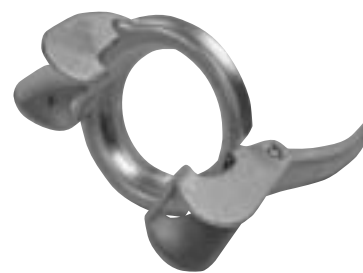

| locking levers galvanized | part number | weight (lbs.) | list price |
|----------------------------|-------------|---------------|------------|
| 2" Lever Locking Ring/Galv | 273 LR2 | 1.05 | 15.72 |
| 3" Lever Locking Ring/Galv | 273 LR3 | 2.35 | 25.69 |
| 4" Lever Locking Ring/Galv | 273 LR4 | 4.45 | 41.53 |
| 5" Lever Locking Ring/Galv | 273 LR5 | 6.40 | 59.88 |
| 6" Lever Locking Ring/Galv | 273 LR6 | 9.25 | 80.68 |
| 8" Lever Locking Ring/Galv | 273 LR8 | 13.00 | 138.05 |



| silicone o-rings | part number | weight (lbs.) | list price |
|--------------------|-------------|---------------|------------|
| 2" Silicone O-Ring | 780 SOR2 | | call |
| 3" Silicone O-Ring | 780 SOR3 | | call |
| 4" Silicone O-Ring | 780 SOR4 | | call |
| 6" Silicone O-Ring | 780 SOR6 | | call |
| 8" Silicone O-Ring | 780 SOR8 | | call |

Wil-loc Stainless Steel Male Hose Tails

vacuum rating 30 inches hg
psi rating 2 & 3 inch = 290
4 - 8 inch = 175
number of ribs 2 & 3 inch = 2
4 - 8 inch = 3
metallurgy 304: standard
316: optional

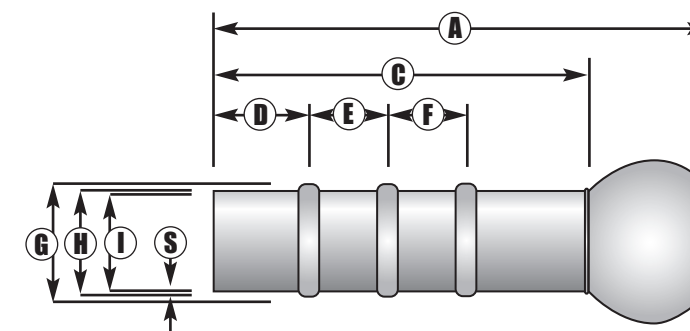

| male mechanical specs. | A | C | D | E | F | G | H | I | S |
|------------------------|-------|------|------|------|------|------|------|------|------|
| 2" 50x50mm | 6.50 | 4.33 | 0.98 | 1.38 | | 2.09 | 1.97 | 1.85 | 0.06 |
| 3" 76x76mm | 8.07 | 5.31 | 1.38 | 1.38 | | 3.11 | 2.99 | 2.87 | 0.06 |
| 4" 108x100mm | 11.42 | 7.28 | 1.38 | 1.77 | 1.77 | 4.09 | 3.94 | 3.80 | 0.07 |
| 5" 133x125mm | 11.61 | 7.87 | 1.38 | 1.77 | 1.77 | 5.08 | 4.92 | 4.78 | 0.07 |
| 6" 159x150mm | 12.40 | 8.66 | 1.57 | 1.97 | 1.97 | 6.06 | 5.91 | 5.77 | 0.07 |
| 8" 194x200mm | 14.96 | 9.84 | 1.97 | 2.36 | 2.36 | 8.11 | 7.87 | 7.71 | 0.08 |

Hose Set Specifications to 1/100th of an inch • Specifications Subject to Change

Wil-loc Stainless Steel Female Hose Tails

vacuum rating 30 inches hg
psi rating 2 & 3 inch = 290
4 - 8 inch = 175
number of ribs 2 & 3 inch = 2
4 - 8 inch = 3
metallurgy 304: standard
316: optional

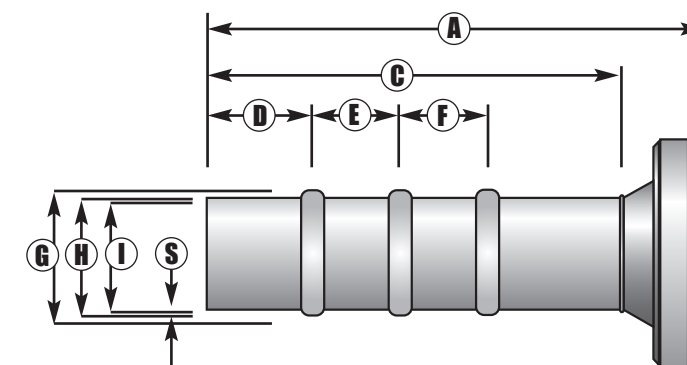

| female mechanical specs. | A | C | D | E | F | G | H | I | S |
|--------------------------|-------|------|------|------|------|------|------|------|------|
| 2" 50x50mm | 5.51 | 4.33 | 0.98 | 1.38 | | 2.09 | 1.97 | 1.85 | 0.06 |
| 3" 76x76mm | 6.69 | 5.31 | 1.38 | 1.38 | | 3.11 | 2.99 | 2.87 | 0.06 |
| 4" 108x100mm | 9.45 | 7.28 | 1.38 | 1.77 | 1.77 | 4.09 | 3.94 | 3.80 | 0.07 |
| 5" 133x125mm | 10.04 | 7.87 | 1.38 | 1.77 | 1.77 | 5.08 | 4.92 | 4.78 | 0.07 |
| 6" 159x150mm | 10.43 | 8.46 | 1.57 | 1.97 | 1.97 | 6.06 | 5.77 | 5.76 | 0.07 |
| 8" 194x200mm | 12.99 | 9.84 | 1.97 | 2.36 | 2.36 | 8.11 | 7.71 | 7.72 | 0.08 |

Hose Set Specifications to 1/100th of an inch • Specifications Subject to Change

Tech Tip

All stainless steel fittings are made with 304 series stainless steel. 316 series stainless steel is available by special order. Locking levers are carbon steel and can be coated if needed.



| discharge flanges (ss) | part number | weight (lbs.) | list price |
|------------------------|-------------|---------------|------------|
| 3" Flange Ball/Male | 810 FS3M | 13.15 | 359.26 |
| 4" Flange Ball/Male | 810 FS4M | 20.60 | 489.74 |
| 6" Flange Ball/Male | 810 FS6M | 39.25 | 761.76 |
| 8" Flange Ball/Male | 810 FS8M | 56.40 | 1,178.43 |

All flanges are designed to meet ASA specifications.



| suction flanges (ss) | part number | weight (lbs.) | list price |
|-------------------------|-------------|---------------|------------|
| 3" Flange Socket/Female | 830 FS3F | 7.70 | 330.31 |
| 4" Flange Socket/Female | 830 FS4F | 10.90 | 447.88 |
| 6" Flange Socket/Female | 830 FS6F | 17.05 | 686.27 |
| 8" Flange Socket/Female | 830 FS8F | 25.15 | 991.82 |

All flanges are designed to meet ASA specifications.



| male threaded long balls (ss) | part number | weight (lbs.) | list price |
|-------------------------------|-------------|---------------|------------|
| 2" Male Thrd/Long/Ball | 820 BMTS2 | 2.50 | 148.95 |
| 3" Male Thrd/Long/Ball | 820 BMTS3 | 8.65 | 243.89 |
| 4" Male Thrd/Long/Ball | 820 BMTS4 | 15.80 | 387.80 |

All threads are cut to NPT specifications.



| male threaded short balls (ss) | part number | weight (lbs.) | list price |
|--------------------------------|-------------|---------------|------------|
| 2" Male Thrd/short/Ball | 822 BMTS2 | 2.00 | 104.02 |
| 3" Male Thrd/short/Ball | 822 BMTS3 | 7.85 | 172.93 |
| 4" Male Thrd/short/Ball | 822 BMTS4 | 14.10 | 288.44 |

All threads are cut to NPT specifications.



| male threaded sockets (ss) | part number | weight (lbs.) | list price |
|----------------------------|-------------|---------------|------------|
| 2" Male Thrd/Socket/Female | 840 SMTS2 | 2.00 | 92.36 |
| 3" Male Thrd/Socket/Female | 840 SMTS3 | 3.30 | 164.08 |
| 4" Male Thrd/Socket/Female | 840 SMTS4 | 5.60 | 258.27 |

All threads are cut to NPT specifications.



| female threaded balls (ss) | part number | weight (lbs.) | list price |
|----------------------------|-------------|---------------|------------|
| 2" Female Thrd/Ball/Male | 825 BFTS2 | 2.50 | 151.28 |
| 3" Female Thrd/Ball/Male | 825 BFTS3 | 8.85 | 263.59 |
| 4" Female Thrd/Ball/Male | 825 BFTS4 | 15.10 | 394.67 |

All threads are cut to NPT specifications.



| female threaded sockets (ss) | part number | weight (lbs.) | list price |
|------------------------------|-------------|---------------|------------|
| 2" Female Thrd/Skt/Female | 845 SFTS2 | 1.75 | 138.17 |
| 3" Female Thrd/Skt/Female | 845 SFTS3 | 4.00 | 252.78 |
| 4" Female Thrd/Skt/Female | 845 SFTS4 | 6.20 | 367.82 |

All threads are cut to NPT specifications.

Wil-loc Stainless Steel Fittings

| | | | |
|---------------|------------------|------------|---------------|
| vacuum rating | 30 inches hg | metallurgy | 304: standard |
| psi rating | 2 & 3 inch = 290 | | 316: optional |
| | 4 - 8 inch = 175 | | |



| 90° elbow (ss) | part number | weight (lbs.) | list price |
|--------------------|-------------|---------------|------------|
| 2" 90 Degree Elbow | 870 ES2-90 | 5.20 | 177.07 |
| 3" 90 Degree Elbow | 870 ES3-90 | 9.85 | 306.69 |
| 4" 90 Degree Elbow | 870 ES4-90 | 19.00 | 504.09 |
| 6" 90 Degree Elbow | 870 ES6-90 | 40.00 | 886.06 |
| 8" 90 Degree Elbow | 870 ES8-90 | 63.50 | 1,399.71 |

| 45° elbow (ss) | part number | weight (lbs.) | list price |
|--------------------|-------------|---------------|------------|
| 2" 45 Degree Elbow | 880 ES2-45 | 4.70 | 177.07 |
| 3" 45 Degree Elbow | 880 ES3-45 | 8.55 | 293.58 |
| 4" 45 Degree Elbow | 880 ES4-45 | 17.00 | 484.02 |
| 6" 45 Degree Elbow | 880 ES6-45 | 34.00 | 797.19 |
| 8" 45 Degree Elbow | 880 ES8-45 | 52.50 | 1,242.61 |

| increasers (ss) | part number | weight (lbs.) | list price |
|-------------------|-------------|---------------|------------|
| 2" x 3" Increaser | 850 INS2-3M | 7.20 | 309.26 |
| 3" x 4" Increaser | 850 INS3-4M | 13.70 | 472.47 |
| 4" x 6" Increaser | 850 INS4-6M | 28.20 | 679.15 |
| 6" x 8" Increaser | 850 INS6-8M | 43.20 | 996.25 |

| reducers (ss) | part number | weight (lbs.) | list price |
|-----------------|-------------|---------------|------------|
| 3" x 2" Reducer | 860 RS3-2M | 4.80 | 312.08 |
| 4" x 3" Reducer | 860 RS4-3M | 9.55 | 451.13 |
| 6" x 4" Reducer | 860 RS6-4M | 17.60 | 688.35 |
| 8" x 6" Reducer | 860 RS8-6M | 36.20 | 959.30 |

Tech Tip

Wil-loc stocks Stainless Steel Weld-On Sets and Standard Hose Sets. All other fittings are made to order. Please allow for extended delivery times.



B-style galvanized pipe shown.

| four inch galvanized pipe | part number | weight (lbs.) | list price |
|---------------------------|-------------|---------------|------------|
| 4" x 6' Galvanized Pipe | 220 P4-6 | 21.00 | call |
| 4" x 10' Galvanized Pipe | 220 P4-10 | 33.00 | call |
| 4" x 20' Galvanized Pipe | 220 P4-20 | 60.00 | call |

| six inch galvanized pipe | part number | weight (lbs.) | list price |
|--------------------------|-------------|---------------|------------|
| 6" x 3' Galvanized Pipe | 220 P6-3 | 28.00 | call |
| 6" x 6' Galvanized Pipe | 220 P6-6 | 35.00 | call |
| 6" x 10' Galvanized Pipe | 220 P6-10 | 55.00 | call |
| 6" x 20' Galvanized Pipe | 220 P6-20 | 93.00 | call |

| eight inch galvanized pipe | part number | weight (lbs.) | list price |
|----------------------------|-------------|---------------|------------|
| 8" x 3' Galvanized Pipe | 220 P8-3 | 43.00 | call |
| 8" x 6' Galvanized Pipe | 220 P8-6 | 52.00 | call |
| 8" x 10' Galvanized Pipe | 220 P8-10 | 78.00 | call |
| 8" x 20' Galvanized Pipe | 220 P8-20 | 120.00 | call |

| ten inch galvanized pipe | part number | weight (lbs.) | list price |
|---------------------------|-------------|---------------|------------|
| 10" x 10' Galvanized Pipe | 221 P10-10 | 63.00 | call |
| 10" x 15' Galvanized Pipe | 221 P10-15 | 165.00 | call |
| 10" x 20' Galvanized Pipe | 221 P10-20 | 209.00 | call |

All ten inch pipe has a-style couplings.

| twelve inch galvanized pipe | part number | weight (lbs.) | list price |
|-----------------------------|-------------|---------------|------------|
| 12" x 10' Galvanized Pipe | 221 P12-10 | 173.00 | call |
| 12" x 15' Galvanized Pipe | 221 P12-15 | 225.00 | call |
| 12" x 20' Galvanized Pipe | 221 P12-20 | 278.00 | call |

All twelve inch pipe has a-style couplings.

| galvanized pipe specs. | I.D. Inches | Wall Inches | Wall Mill. | Max P.S.I. | Vacuum |
|------------------------|-------------|-------------|------------|------------|--------|
| 4" Galvanized Pipe | 4.25 | 0.059 | 1.5 | 175 | 30 |
| 6" Galvanized Pipe | 6.00 | 0.059 | 1.5 | 175 | 30 |
| 8" Galvanized Pipe | 8.00 | 0.059 | 1.5 | 175 | 30 |
| 10" Galvanized Pipe | 10.00 | 0.079 | 2.0 | 88 | 30 |
| 12" Galvanized Pipe | 12.00 | 0.079 | 2.0 | 88 | 30 |

Specifications to 1/8th of an inch • Specifications Subject to Change



B-style aluminum pipe shown.

| three inch aluminum pipe | part number | weight (lbs.) | list price |
|--------------------------|-------------|---------------|------------|
| 3" x 10' Aluminum Pipe | 720 PA3-10 | 15.00 | call |
| 3" x 20' Aluminum Pipe | 720 PA3-20 | 22.00 | call |
| 3" x 30' Aluminum Pipe | 720 PA3-30 | 29.00 | call |

Custom lengths available upon request.

| four inch aluminum pipe | part number | weight (lbs.) | list price |
|-------------------------|-------------|---------------|------------|
| 4" x 10' Aluminum Pipe | 720 PA4-10 | 24.00 | call |
| 4" x 20' Aluminum Pipe | 720 PA4-20 | 35.00 | call |
| 4" x 30' Aluminum Pipe | 720 PA4-30 | 46.00 | call |

Custom lengths available upon request.

| six inch aluminum pipe | part number | weight (lbs.) | list price |
|------------------------|-------------|---------------|------------|
| 6" x 10' Aluminum Pipe | 720 PA6-10 | 46.00 | call |
| 6" x 20' Aluminum Pipe | 720 PA6-20 | 64.00 | call |
| 6" x 30' Aluminum Pipe | 720 PA6-30 | 82.00 | call |

Custom lengths available upon request.

| eight inch aluminum pipe | part number | weight (lbs.) | list price |
|--------------------------|-------------|---------------|------------|
| 8" x 10' Aluminum Pipe | 720 PA8-10 | 68.00 | call |
| 8" x 20' Aluminum Pipe | 720 PA8-20 | 96.00 | call |

Custom lengths available upon request.

| aluminum pipe specs. | Fittings | I.D. Inches | Wall Mill. | Max P.S.I. | Vacuum |
|----------------------|------------|-------------|------------|------------|--------|
| 3" Aluminum Pipe | Cast Alum. | 3.00 | 0.065 | 290 | 30 |
| 4" Aluminum Pipe | Cast Alum. | 4.00 | 0.072 | 175 | 30 |
| 6" Aluminum Pipe | Cast Alum. | 6.00 | 0.083 | 175 | 30 |
| 8" Aluminum Pipe | Cast Alum. | 8.00 | 0.090 | 175 | 30 |

Specifications to 1/8th of an inch • Specifications Subject to Change

Tech Tip

Wil-loc's industrial-grade Galvanized and Aluminum Pipe is fully vacuum rated. Vacuum ratings are dependent on the wall thickness of the pipe. For thinner walled pipe, vacuum relief valves should be used to prevent pipe from collapsing.

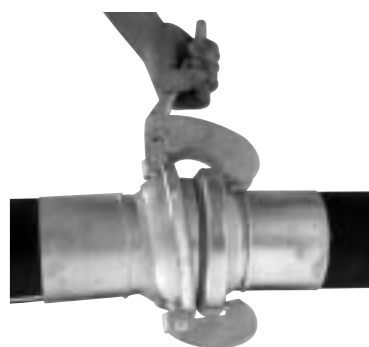

| HDPE transition fitting set | part number | weight (lbs.) | list price |
|------------------------------|-------------|---------------|------------|
| 2" HDPE Transition Assembly | 910 HDTGA2 | 5.00 | 192.53 |
| 3" HDPE Transition Assembly | 910 HDTGA3 | 10.50 | 221.68 |
| 4" HDPE Transition Assembly | 910 HDTGA4 | 19.00 | 276.66 |
| 6" HDPE Transition Assembly | 910 HDTGA6 | 39.00 | 418.87 |
| 8" HDPE Transition Assembly | 910 HDTGA7 | 58.00 | 706.73 |
| 10" HDPE Transition Assembly | 911 HDTGA10 | 79.00 | 857.10 |
| 12" HDPE Transition Assembly | 911 HDTGA12 | 160.00 | 1,116.43 |

10 & 12 inch transition fittings are A-Style fittings.

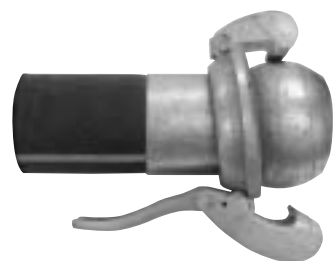

| HDPE transition male fitting | part number | weight (lbs.) | list price |
|------------------------------|--------------|---------------|------------|
| 2" HDPE Transition Male | 920 HDPEMG2 | 2.00 | 103.49 |
| 3" HDPE Transition Male | 920 HDPEMG3 | 4.00 | 122.80 |
| 4" HDPE Transition Male | 920 HDPEMG4 | 7.50 | 158.00 |
| 6" HDPE Transition Male | 920 HDPEMG6 | 15.00 | 244.00 |
| 8" HDPE Transition Male | 920 HDPEMG8 | 23.00 | 413.46 |
| 10" HDPE Transition Male | 921 HDPEMG10 | 35.00 | 436.99 |
| 12" HDPE Transition Male | 921 HDPEMG12 | 73.00 | 551.28 |

Price Includes Locking Rings.



| HDPE transition female fitting | part number | weight (lbs.) | list price |
|--------------------------------|--------------|---------------|------------|
| 2" HDPE Transition Female | 940 HDPEFG2 | 2.00 | 89.05 |
| 3" HDPE Transition Female | 940 HDPEFG3 | 4.00 | 98.88 |
| 4" HDPE Transition Female | 940 HDPEFG4 | 7.50 | 118.67 |
| 6" HDPE Transition Female | 940 HDPEFG6 | 15.00 | 173.99 |
| 8" HDPE Transition Female | 940 HDPEFG8 | 23.00 | 293.27 |
| 10" HDPE Transition Female | 941 HDPEFG10 | 35.00 | 420.11 |
| 12" HDPE Transition Female | 941 HDPEFG12 | 73.00 | 565.15 |

10 & 12 inch transition fittings are A-Style fittings.

HDPE Fused Transition, High Pressure Fittings

stub ends HDPE SDR11
inserts tapped & coned

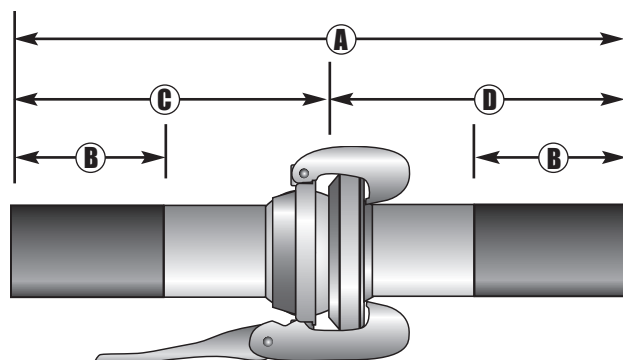

| HDPE transition specs. | A | B | C | D |
|------------------------|-------|------|-------|-------|
| 2" HDPE Transition | 22.25 | 6.00 | 12.00 | 10.75 |
| 3" HDPE Transition | 23.25 | 6.00 | 13.00 | 11.00 |
| 4" HDPE Transition | 25.50 | 6.00 | 14.25 | 11.75 |
| 6" HDPE Transition | 27.00 | 6.00 | 15.50 | 12.50 |
| 8" HDPE Transition | 32.25 | 6.00 | 18.00 | 15.25 |
| 10" HDPE Transition | 38.75 | 6.00 | 21.25 | 18.75 |
| 12" HDPE Transition | 41.00 | 6.00 | 22.75 | 19.50 |

Specifications to 1/8th of an inch. Subject to change.



B-style fitting shown.



| B-Style HDPE insert fittings | part number | weight (lbs.) | list price |
|------------------------------|-------------|---------------|------------|
| 2" Hose Set Assembly | 275 HSA2 | 2.60 | 38.05 |
| 3" Hose Set Assembly | 275 HSA3 | 5.30 | 59.40 |
| 4" Hose Set Assembly | 275 HSA4 | 11.70 | 106.25 |
| 6" Hose Set Assembly | 275 HSA6 | 21.70 | 189.40 |
| 8" Hose Set Assembly | 275 HSA8 | 35.70 | 369.75 |

| A-Style HDPE insert fittings | part number | weight (lbs.) | list price |
|------------------------------|-------------|---------------|------------|
| 10" Hose Set Assembly | 276 HSA10 | 55.04 | 434.35 |
| 12" Hose Set Assembly* | 276 HSA12 | 89.60 | 721.80 |

* 12" Hose Set Assembly comes with a locking bar.

| HDPE single bolt clamps | part number | weight (lbs.) | list price |
|-------------------------|-------------|---------------|------------|
| 2" HDPE Clamp | 302 CS2 | 59-63 | 5.00 |
| 3" HDPE Clamp | 302 CS3 | 85-91 | 8.00 |
| 4" HDPE Clamp | 302 CS4 | 112-121 | 9.20 |
| 6" HDPE Clamp | 302 CS6 | 162-174 | 14.50 |
| 8" HDPE Clamp | 302 CS8 | 213-226 | 16.00 |
| 10" HDPE Clamp | 302 CS10 | 265-278 | 38.00 |
| 12" HDPE Clamp | 302 C12 | 317-330 | 45.20 |

HDPE Press-In Fittings

male hose barb

female hose barb



| HDPE specs. | P.S.I.* | Weight/Ft. | Clamp |
|--------------------------------|-----------|----------------|---------|
| 2" SDR 11 / SDR 17 | 160/100 | 0.64/0.43 | 59-63 |
| 3" SDR 17 / SDR 21 | 100/80 | 0.93/0.77 | 85-91 |
| 4" SDR 17 / SDR 21 / SDR 26 | 100/80/64 | 1.54/1.26/1.03 | 112-121 |
| 6" SDR 17 / SDR 21 / SDR 26 | 100/80/64 | 3.34/2.73/2.23 | 162-174 |
| 8" SDR 21 / SDR 26 / SDR 32.5 | 80/64/51 | 4.64/3.79/3.05 | 213-226 |
| 10" SDR 21 / SDR 26 / SDR 32.5 | 80/64/51 | 7.21/5.87/4.73 | 265-278 |
| 12" SDR 26 / SDR 32.5 | 64/51 | 8.26/6.67 | 317/330 |

HDPE expands / contracts at 1" / 100' for every 10° temperature variance from 70°



| PVC single bolt clamps | part number | mm range | list price |
|------------------------|-------------|----------|------------|
| 2" PVC Discharge | 302 CD2 | 51-55 | 5.20 |
| 3" PVC Discharge | 302 CD3 | 79-85 | 7.95 |
| 4" PVC Discharge | 302 CD4 | 104-112 | 9.10 |
| 5" PVC Discharge | 302 CD5 | 130-140 | 13.60 |
| 6" PVC Discharge | 302 CD6 | 150-162 | 14.15 |
| 8" PVC Discharge | 302 CD8 | 200-213 | 15.70 |

| rubber single bolt clamps | part number | mm range | list price |
|---------------------------|-------------|----------|------------|
| 2" Rubber Discharge | 302 CD2X | 55-59 | 5.40 |
| 3" Rubber Discharge | 302 CS3 | 85-91 | 8.00 |
| 4" Rubber Discharge | 302 CD4X | 121-130 | 9.60 |
| 6" Rubber Discharge | 302 CD6X | 174-187 | 14.90 |
| 8" Rubber Discharge | 302 CS8 | 213-226 | 16.00 |

| suction single bolt clamps | part number | mm range | list price |
|----------------------------|-------------|----------|------------|
| 2" PVC/Rubber Suction | 302 CS2 | 59-63 | 5.00 |
| 3" PVC/Rubber Suction | 302 CS3 | 85-91 | 8.00 |
| 4" PVC/Rubber Suction | 302 CS4 | 112-121 | 9.20 |
| 5" PVC/Rubber Suction | 302 CS5 | 140-150 | 13.80 |
| 6" PVC/Rubber Suction | 302 CS6 | 162-174 | 14.50 |
| 8" PVC/Rubber Suction | 302 CS8 | 213-226 | 16.00 |



The bolt is made from high grade steel, zinc plated (W2) or stainless steel (W4).



Only regular tools are needed to tighten the bolt. Deep sockets to reach a nut are not required.



The stainless steel band has beveled edges to prevent damage to the hose.



| lever locking safety pins | part number | weight (lbs.) | list price |
|---------------------------|-------------|---------------|------------|
| 2" lever locking pin | 009 LLSP2 | | 2.50 |
| 3" lever locking pin | 009 LLSP3 | | 2.50 |
| 4" lever locking pin | 009 LLSP4 | | 3.75 |
| 6" lever locking pin | 009 LLSP6 | | 3.75 |
| 8" lever locking pin | 009 LLSP8 | | 3.75 |



| PVC ball valves | part number | weight (lbs.) | list price |
|-------------------|-------------|---------------|------------|
| 2" PVC Ball Valve | 170 PVCBA2 | | 79.54 |
| 3" PVC Ball Valve | 170 PVCBA3 | | 190.69 |
| 4" PVC Ball Valve | 170 PVCBA4 | | 358.80 |

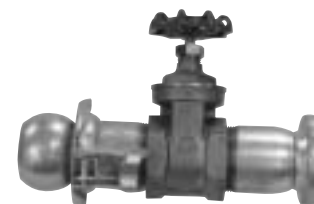

| brass gate valves | part number | weight (lbs.) | list price |
|---------------------|-------------|---------------|------------|
| 2" Brass Gate Valve | 172 BGVA2 | | 84.83 |
| 3" Brass Gate Valve | 172 BGVA3 | | 166.63 |
| 4" Brass Gate Valve | 172 BGVA4 | | 286.74 |



| brass check valves | part number | weight (lbs.) | list price |
|----------------------|-------------|---------------|------------|
| 2" Brass Check Valve | 173 BCVA2 | | 100.50 |
| 3" Brass Check Valve | 173 BCVA3 | | 213.58 |
| 4" Brass Check Valve | 173 BCVA4 | | 359.51 |



| flanged check valves | part number | weight (lbs.) | list price |
|----------------------------|-------------|---------------|------------|
| 4" Galvanized Check Valve | 174 FGCVA4 | | 1,011.44 |
| 6" Galvanized Check Valve | 174 FGCVA6 | | 1,112.77 |
| 8" Galvanized Check Valve | 174 FGCVA8 | | 1,427.73 |
| 10" Galvanized Check Valve | 174 FGCVA10 | | 1,810.11 |
| 12" Galvanized Check Valve | 174 FGCVA12 | | 2,558.39 |

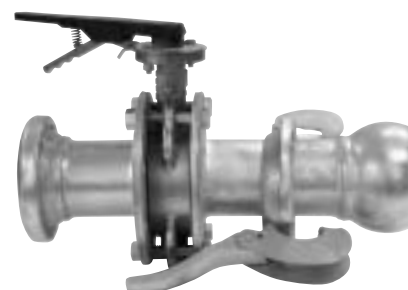

| flanged butterfly valves | part number | weight (lbs.) | list price |
|---------------------------|-------------|---------------|------------|
| 4" Galv. Butterfly Valve | 171 BFVA4 | | 565.80 |
| 6" Galv. Butterfly Valve | 171 BFVA6 | | 903.01 |
| 8" Galv. Butterfly Valve | 171 BFVA8 | | 1,275.73 |
| 10" Galv. Butterfly Valve | 171 BFVA10 | | 1,732.83 |
| 12" Galv. Butterfly Valve | 171 BFVA12 | | 2,492.03 |

Note: Stand-alone valves are available for purchase.

Tech Tip

Most hoses expand and contract with weather and heavy usage. Wil-loc Bolt Clamps are designed to allow adjustment in the field. To tighten your Wil-loc Clamps, or to remove your valuable hose ends, all you need is an adjustable wrench.

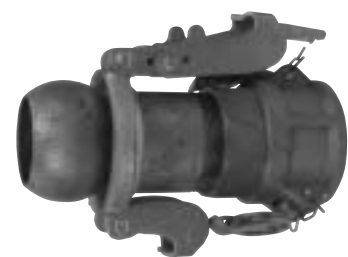

| female cam to male ball | part number | weight (lbs.) | list price |
|-------------------------|-------------|---------------|------------|
| 2" Female Cam-lock Male | 028 BFC2 | 3.00 | 49.15 |
| 3" Female Cam-lock Male | 028 BFC3 | 6.00 | 75.76 |
| 4" Female Cam-lock Male | 028 BFC4 | 11.00 | 129.67 |
| 6" Female Cam-lock Male | 028 BFC6 | 21.00 | 240.05 |



| male cam to male ball | part number | weight (lbs.) | list price |
|-----------------------|-------------|---------------|------------|
| 2" Male Cam-lock Male | 027 BMC2 | 3.00 | 41.27 |
| 3" Male Cam-lock Male | 027 BMC3 | 6.00 | 102.46 |
| 4" Male Cam-lock Male | 027 BMC4 | 11.00 | 114.55 |
| 6" Male Cam-lock Male | 027 BMC6 | 21.00 | 208.13 |



| female cam to female skt. | part number | weight (lbs.) | list price |
|---------------------------|-------------|---------------|------------|
| 2" Female Cam-lock Socket | 048 SFC2 | 2.00 | 33.28 |
| 3" Female Cam-lock Socket | 048 SFC3 | 4.00 | 49.60 |
| 4" Female Cam-lock Socket | 048 SFC4 | 5.00 | 87.44 |
| 6" Female Cam-lock Socket | 048 SFC6 | 15.00 | 162.61 |



| male cam to female socket | part number | weight (lbs.) | list price |
|---------------------------|-------------|---------------|------------|
| 2" Male Cam-lock Socket | 047 SMC2 | 2.00 | 25.40 |
| 3" Male Cam-lock Socket | 047 SMC3 | 4.00 | 35.03 |
| 4" Male Cam-lock Socket | 047 SMC4 | 5.00 | 72.32 |
| 6" Male Cam-lock Socket | 047 SMC6 | 15.00 | 130.69 |

Tech Tip

The 2" - 6" Cam-lock components used for Wil-loc's Cam-lock adapters are manufactured to MIL-C-274878F specifications. Conformance to this specification assures complete compatibility and product quality control.

Wil-loc offers a wide range of adapters. Contact Wil-loc for any adapter configuration.



| victaulic to male balls | part number | weight (lbs.) | list price |
|-------------------------|-------------|---------------|------------|
| 2" Vic / Male Wil-loc | 930 VICMG2 | 3.20 | 70.24 |
| 3" Vic / Male Wil-loc | 930 VICMG3 | 6.55 | 95.22 |
| 4" Vic / Male Wil-loc | 930 VICMG4 | 10.00 | 133.02 |
| 6" Vic / Male Wil-loc | 930 VICMG6 | 21.50 | 226.55 |
| 8" Vic / Male Wil-loc | 930 VICMG8 | 32.25 | 362.46 |
| 10" Vic / Male Wil-loc | 931 VICMG10 | 49.50 | 331.97 |
| 12" Vic / Male Wil-loc | 931 VICMG12 | 77.25 | 475.30 |

Note: Clamps sold separately



| victaulic to female sockets | part number | weight (lbs.) | list price |
|-----------------------------|-------------|---------------|------------|
| 2" Vic / Female Wil-loc | 932 VICFG2 | 2.10 | 53.63 |
| 3" Vic / Female Wil-loc | 932 VICFG3 | 4.30 | 67.71 |
| 4" Vic / Female Wil-loc | 932 VICFG4 | 5.50 | 87.80 |
| 6" Vic / Female Wil-loc | 932 VICFG6 | 12.50 | 145.03 |
| 8" Vic / Female Wil-loc | 932 VICFG8 | 19.25 | 224.24 |
| 10" Vic / Female Wil-loc | 933 VICFG10 | 42.50 | 324.89 |
| 12" Vic / Female Wil-loc | 933 VICFG12 | 75.25 | 526.32 |



| female ring-lock to male balls | part number | weight (lbs.) | list price |
|--------------------------------|-------------|---------------|------------|
| 4" Female / Male Wil-loc | 934 FCMG4 | 7.25 | 100.69 |
| 6" Female / Male Wil-loc | 934 FCMG6 | 14.50 | 151.44 |
| 8" Female / Male Wil-loc | 934 FCMG8 | 22.25 | 248.68 |
| 10" Female / Male Wil-loc | 935 FCMG10 | 23.15 | 198.10 |
| 12" Female / Male Wil-loc | 935 FCMG12 | 38.75 | 318.09 |

Note: Clamps sold separately



| male ring-lock to sockets | part number | weight (lbs.) | list price |
|---------------------------|-------------|---------------|------------|
| 4" Male / Female Wil-loc | 936 MCFG4 | 2.50 | 49.60 |
| 6" Male / Female Wil-loc | 936 MCFG6 | 5.75 | 79.55 |
| 8" Male / Female Wil-loc | 936 MCFG8 | 8.50 | 123.68 |
| 10" Male / Female Wil-loc | 937 MCFG10 | 20.00 | 193.64 |
| 12" Male / Female Wil-loc | 937 MCFG12 | 37.75 | 367.85 |



| ban-lock to male aluminum | part number | weight (lbs.) | list price |
|---------------------------|-------------|---------------|------------|
| 6" Female / Aluminum Ball | 938BM A6 | 16.00 | 234.39 |
| 8" Female / Aluminum Ball | 938BM A8 | 21.00 | 376.56 |

Note: Clamps sold separately



| ban-lock to female aluminum | part number | weight (lbs.) | list price |
|-----------------------------|-------------|---------------|------------|
| 6" Male / Aluminum Socket | 939BF A6 | 7.00 | 110.35 |
| 8" Male / Aluminum Socket | 939BF A8 | 9.50 | 176.76 |

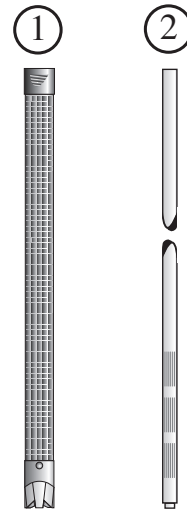

| 1. self jetting wellpoints | part number | weight (lbs.) | list price |
|--------------------------------|-------------|---------------|------------|
| 18" Stainless Steel Wellpoints | 141 WPS-1 | 8.00 | 160.00 |
| 28" Stainless Steel Wellpoints | 141 WPS | 11.00 | 184.00 |
| screen size .012 | | | |

| 2. PVC wellpoints | part number | weight (lbs.) | list price |
|---------------------------------------------------------|-------------|---------------|------------|
| 1.5" x 20' Wellpoint Fine | 141 WPP F | 10.00 | 60.00 |
| 1.5" x 20' Wellpoint Medium | 141 WPP M | 10.00 | 60.00 |
| 1.5" x 20' Wellpoint Coarse | 141 WPP C | 11.00 | 60.00 |
| screen sizes; fine = .010, medium = .016, coarse = .025 | | | |

| steel wellpoint accessories | part number | weight (lbs.) | list price |
|------------------------------|-------------|---------------|------------|
| 2" Socket x 1.5" Female Thrd | 142 SFT | 1.00 | 26.30 |
| 2" Socket x 1.5" Male Thrd | 142 SMT | 1.00 | 24.70 |
| 2" Socket x 2.0" Female Thrd | 142 SFT2 | 1.00 | 24.70 |

| four inch header pipes | part number | weight (lbs.) | list price |
|----------------------------|-------------|---------------|------------|
| 4" x 10' Header / 3 inlets | 140 H4-10-3 | 41.00 | call |
| 4" x 10' Header / 6 inlets | 140 H4-10-6 | 44.00 | call |
| 4" x 20' Header / 6 inlets | 140 H4-20-6 | 66.00 | call |

| six inch header pipes | part number | weight (lbs.) | list price |
|------------------------------------------------------------------|-------------|---------------|------------|
| 6" x 3' Header / 1 inlet | 140 H6-3 | 34.00 | call |
| 6" x 6' Header / 2 inlets | 140 H6-6 | 47.00 | call |
| 6" x 10' Header / 3 inlets | 140 H6-10 | 63.00 | call |
| 6" x 10' Header / 9 inlets | 140 H6-10-9 | 69.00 | call |
| 6" x 20' Header / 6 inlets | 140 H6-20 | 99.00 | call |
| 8" galvanized steel wellpoint header pipe available upon request | | | |

| galvanized header pipe specs. | I.D. | Wall Thickness | W.P. P.S.I. | Vac. Rating |
|--------------------------------------------------------|------|----------------|-------------|-------------|
| 4" Galvanized Steel Header | 4.25 | 0.071 | 175 | 28 hg. |
| 6" Galvanized Steel Header | 6.00 | 0.071 | 175 | 28 hg. |
| Specifications to 1/8th of an inch & Subject to Change | | | | |

Note: 8" Galvanized Steel Header is available. Please allow extra time for delivery.

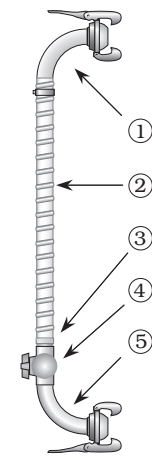
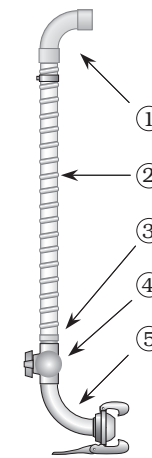

| PVC wellpoint swingers | part number | weight (lbs.) | list price |
|------------------------------|-------------|---------------|------------|
| 3' PVC Wellpoint Swinger As. | 141 SWPA | 5.00 | 114.90 |
| 6' PVC Wellpoint Swinger As. | 141 SWPA-6 | 6.00 | 133.40 |
| 9' PVC Wellpoint Swinger As. | 141 SWPA-9 | 8.00 | 152.00 |

| PVC swinger components | part number | weight (lbs.) | list price |
|------------------------------|-------------|---------------|------------|
| 1. PVC Riser to Hose Adapter | 142 PRA | | 5.75 |
| 2. Swinger Hose 1.5" x 36" | 142 WFHA | | 17.25 |
| 3. PVC Adapter to Threaded | 142 PAT | | 3.45 |
| 4. PVC Ball Valve / Threaded | 142 PBV | | 23.00 |
| 5. 2" B 90 x 1.5" Male Thrd. | 142 B9MT | | 46.15 |

| steel wellpoint swingers | part number | weight (lbs.) | list price |
|--------------------------|-------------|---------------|------------|
| 3' Wellpoint Swinger As. | 141 SWSPA | 8.00 | 140.80 |
| 6' Wellpoint Swinger As. | 141 SWSPA-6 | 9.00 | 158.30 |
| 9' Wellpoint Swinger As. | 141 SWSPA-9 | 11.00 | 177.10 |

| steel wellpoint swingers | part number | weight (lbs.) | list price |
|------------------------------|-------------|---------------|------------|
| 1. 2" B 90 x 1.5" Male Tail | 142 B9H | | 28.90 |
| 2. Swinger Hose 1.5" x 36" | 142 WFHA | | 18.50 |
| 3. PVC Adapter to Threaded | 142 PAT | | 3.45 |
| 4. PVC Ball Valve / Threaded | 142 PBV | | 23.00 |
| 5. 2" B 90 x 1.5" Male Thrd. | 142 B9MT | | 46.10 |

| swinger hose extensions | part number | weight (lbs.) | list price |
|-------------------------------|-------------|---------------|------------|
| 3' Swinger Hose Extension As. | 142 SHEA-3 | | 33.95 |
| 6' Swinger Hose Extension As. | 142 SHEA-6 | | 44.85 |
| 9' Swinger Hose Extension As. | 142 SHEA-9 | | 60.95 |

Tech Tip

All of Wil-loc's standard Wellpoint Swingers come with bright red PVC ball valve handles. This makes it very easy for the operator to tell which valves are open and which are closed.

Strainer Baskets specifications and usage

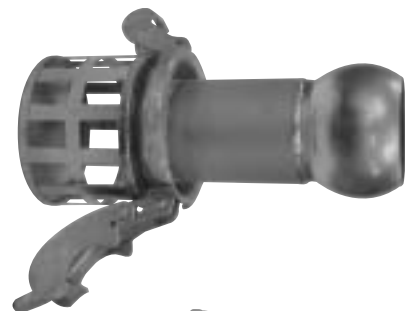
Prices and discount structures subject to change without notice.

| square strainer baskets | part number | weight (lbs.) | list price |
|-----------------------------|-------------|---------------|------------|
| 2" 2Pc/w/Threaded Ball/Male | 316 SBTSA2C | 4.50 | 54.07 |
| 3" 2Pc/w/Threaded Ball/Male | 316 SBTSA3C | 8.05 | 83.41 |
| 4" 2Pc/w/Threaded Ball/Male | 316 SBTSA4C | 14.00 | 132.12 |
| 6" 2Pc/w/Threaded Ball/Male | 316 SBTSA6C | 27.15 | 268.10 |
| 8" 2Pc/w/Threaded Ball/Male | 316 SBTSA8C | 58.55 | 695.87 |

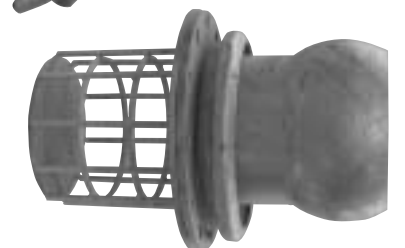

| square strainer baskets | part number | weight (lbs.) | list price |
|------------------------------|--------------|---------------|------------|
| 10" 2Pc Flange Strainer Ball | 316 SBTSA10C | 85.00 | 984.22 |
| 12" 2Pc Flange Strainer Ball | 316 SBTSA12C | 114.00 | 1,254.42 |

A-Style coupling

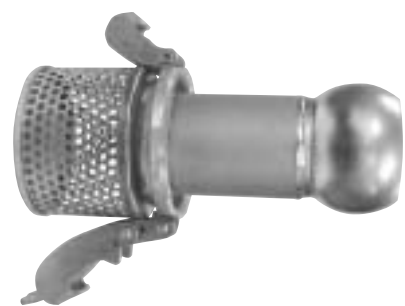

| round strainer baskets | part number | weight (lbs.) | list price |
|-----------------------------|-------------|---------------|------------|
| 2" 2Pc/w/Threaded Ball/Male | 319 SBTRA2C | 4.90 | 53.47 |
| 3" 2Pc/w/Threaded Ball/Male | 319 SBTRA3C | 8.75 | 81.61 |
| 4" 2Pc/w/Threaded Ball/Male | 319 SBTRA4C | 13.20 | 132.24 |
| 6" 2Pc/w/Threaded Ball/Male | 319 SBTRA6C | 26.95 | 267.50 |
| 8" 2Pc/w/Threaded Ball/Male | 319 SBTRA8C | 51.40 | 506.99 |

| round strainer baskets | part number | weight (lbs.) | list price |
|--------------------------|--------------|---------------|------------|
| 10" 2Pc/w/Thrd Ball/Male | 319 SBTRA10C | 53.00 | call |
| 12" 2Pc/w/Thrd Ball/Male | 319 SBTRA12C | 78.00 | call |

A-Style coupling



| square strainer baskets | part number | weight (lbs.) | list price |
|----------------------------|-------------|---------------|------------|
| 10" Flange Square Strainer | 316 SFSB10 | 42.00 | 366.00 |
| 12" Flange Square Strainer | 316 SFSB12 | 48.00 | 436.00 |

A-Style coupling



| square replacement baskets | part number | weight (lbs.) | list price |
|----------------------------|-------------|---------------|------------|
| 2" Replacement Basket | 317 STRB2 | 1.40 | 13.52 |
| 3" Replacement Basket | 317 STRB3 | 1.95 | 21.16 |
| 4" Replacement Basket | 317 STRB4 | 2.48 | 22.92 |
| 6" Replacement Basket | 317 STRB6 | 6.05 | 65.24 |
| 8" Replacement Basket | 317 STRB8 | 21.00 | 307.68 |



| round replacement baskets | part number | weight (lbs.) | list price |
|---------------------------|-------------|---------------|------------|
| 2" Replacement Basket | 318 STRB2 | 1.80 | 12.92 |
| 3" Replacement Basket | 318 STRB3 | 2.65 | 19.36 |
| 4" Replacement Basket | 318 STRB4 | 2.60 | 22.44 |
| 6" Replacement Basket | 318 STRB6 | 5.80 | 64.64 |
| 8" Replacement Basket | 318 STRB8 | 13.00 | 118.80 |

Wil-loc Custom Fabrication

Wil-loc knows that no job is the same. Sometimes having the right part or piece of equipment can turn a nightmare job into a smooth one. While we have tried to assemble a complete line of quality products for your industrial plumbing needs, sometimes you need a custom piece to get the job done.

Contact Wil-loc and talk to our system specialists to design the perfect custom piece of Wil-loc plumbing.

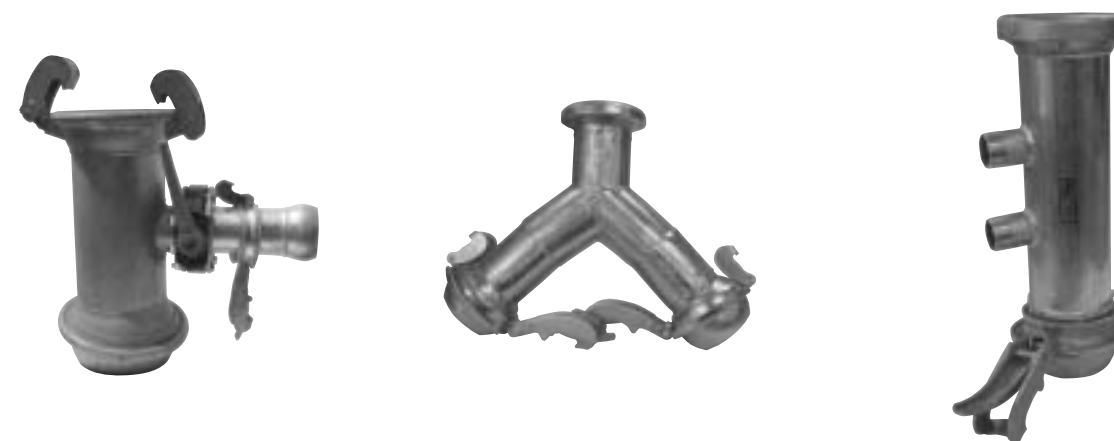
Tech Tip

Round-hole strainer baskets should be used in clean water applications. With liquids that are higher in viscosity than 1.0 weight, square-hole strainers should be used. While the round-hole strainers will filter out larger solids, they are also more likely to clog.

terms & conditions

Acceptance

Unless otherwise stated herein, quotations must be accepted by a purchase order or purchase order acknowledgement in writing within thirty (30) days from the date of the quotation or before shipment of product; whichever is first. All quantities are estimates only. The customer is responsible for actual item quantities required for completion of scope of work. Prices quoted are based upon quantity as indicated. All shipments are subject to prior approval of Purchaser's credit.

Terms of Payment

Terms are 2% ten (10) days or net thirty (30) days from invoice date, unless otherwise agreed to in writing. Retainage will not be accepted at any terms. All amounts due bear interest during the time they remain unpaid at a rate of 1.5% per month (18% per annum). If the Purchaser shall fail to make payments in accordance to the terms agreed upon, the Seller may defer further shipment until such payments are made or terminate the contract. The Seller may otherwise defer shipment, require payment for any shipment hereunder in advance or terminate the contract if the Purchaser's financial responsibility becomes unsatisfactory to the Seller. Minimum order is \$25.

Availability

Availability is based upon current inventory levels and production schedules as of the date of the quote. Actual availability can only be determined on the date the order is placed.

Sales Tax

Unless specifically stated otherwise, quoted prices do not include tax. We are required by law to collect all applicable state and local taxes on orders shipped within Minnesota, and on product the customer picks up at the seller's location. If Purchaser is tax exempt, Purchaser must submit certificate of exemption for Seller's files.

Liability & Warranty

Having no control over the use of the products of this quote, we assume no liability connected with their use. Under no circumstances is the Seller liable for any loss, damage, or expenses of any kind arising out of the use or inability to use our products. All products are covered by normal manufacturer's warranties. No representative of American Pump Company has the authority to waive, alter, or add provisions to this warranty. This warranty is EXPRESSLY IN LIEU OF ANY OTHER WARRANTIES, EXPRESSED OR IMPLIED, INCLUDING BUT NOT LIMITED TO, any implied warranty or merchantability or fitness for a particular purpose. The buyer's sole and exclusive remedy against American Pump Co., Inc. shall be for the repair or replacement, at the option of American Pump Co., Inc., of defective products as provided herein. No other remedy (including, but not limited to, incidental or consequential damages for lost profits, lost sales, injury to person or property, or any other incidentals or consequential loss) shall be available to buyer.

Price/Freight Rates

Freight is FOB Shipping Point unless stated otherwise. All freight quotes are estimates only and are subject to actual costs incurred. If the Purchaser requests product to be shipped to a location other than the quoted shipping point, Purchaser is responsible for additional freight costs. Orders that are in stock can be shipped the same day. Most orders are shipped UPS unless instructed otherwise. Oversized or heavy items are shipped via motor freight. If overnight or next day delivery is needed, Seller will ship merchandise by any available express service of Purchaser's choosing at Purchaser's expense.

Shipping Errors

Any error in weight, number or other specifications must be noted on the bill of lading, and any claim arising therefore must be made in writing within ten (10) days after the receipt by the Purchaser of the equipment, material or goods sold.

Cancellations

Any order is not subject to cancellation as a whole or in part, and is not subject to change without approval of the Seller. At the Seller's option, changes or cancellations may be made without extra charge on items on which work has not begun. Cancellations of any items on which work has begun will be accepted only upon payment of reasonable charges, taking into account expenses already incurred, and commitments already made by Seller.

Force Majeure

The Seller shall not be responsible for any direct or indirect damages whatsoever cause by the delays beyond the control of the Seller, and without limiting the generality of the foregoing it shall not be responsible for any damages due to delays cause by fires, strikes, lockouts, labor difficulties, material procedure delays, or any other cause beyond its control.

Damage in Shipment

Despite our best efforts, items may occasionally be damaged in transit. Freight carriers are liable for damages only when damage is indicated on the bill of lading before you sign for the shipment. Therefore, we recommend that you inspect the outside and contents of all cartons received. If any damage is found, write details on the bill of lading and save the shipment, including the outside container and inside packing material. Ask the delivery carrier to make an inspection immediately. Per ICC regulations, it is the responsibility of the consignee to file a damage claim with the carrier promptly after inspection.

Returned Material

The amount of credit, if any, allowed to the Purchaser for the materials returned, shall be the sole discretion of the Seller. Most items may be returned within 30 days of receipt. Please call, fax or write our Customer Service Department for a Return Authorization Number and shipping instructions prior to return. Our standard restocking charge is 25%. Shipping charges should be prepaid unless otherwise arranged in advance. All merchandise must be carefully packed and will be subject to a charge if not in saleable condition.

All prices, terms and conditions of sale are subject to change without prior notice. Buyer agrees to all terms and conditions of Seller upon the placement of any and all purchase orders.

Wil-loc Assembly Instructions

B- Style Assembly Procedure

Before coupling new fittings, lightly lubricate the O-Rings with a multipurpose, synthetic grease or a non-petroleum based rubber lubricant. This will extend the life of the O-Ring and provide a smoother, easier coupling action to your Wil-loc fitting

Step 1:

Insert the ball into the socket so that the ball seats loosely against the O-ring inside the socket.

Step #1

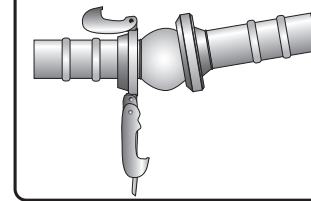

Step 2:

Reach around the socket with the "short" locking jaw and seat its gripping edge securely into the grooved lip on the back side of the socket.

Step #2

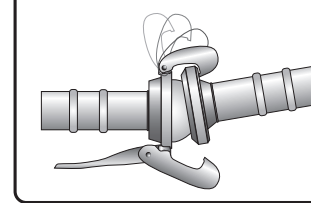

Step 3:

While keeping tension on the "short" locking jaw so that it remains in place, open the lever arm attached to the "long" locking jaw so that it extends to reach behind the socket and seat securely into the groove lip.

Step #3

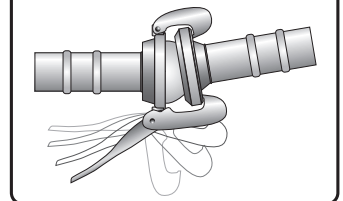

Step 4:

Finally, ensure that the leading edge of the ball is aligned just enough so that it does not cut into the O-ring surface, then close the lever arm (or pull back towards the barbed hose shank) and lock the ball into the socket.

Step #4

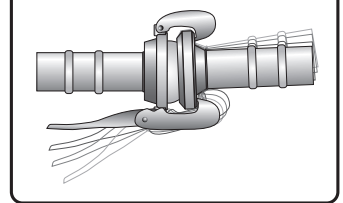

A- Style Assembly Procedure

Step 1:

Insert the ball into the socket so that the ball seats loosely against the O-ring inside the socket.

Step #1

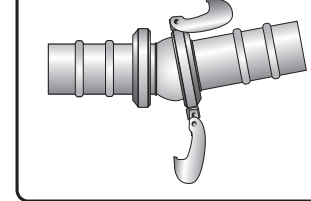

Step 2:

Reach around the locking ring with the "short" locking jaw and seat its gripping edge securely into the grooved lip on the back side of the locking ring.

Step #2

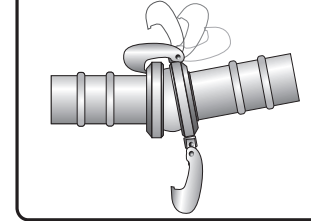

Step 3:

While keeping tension on the "short" locking jaw so that it remains in place, extend the "long" locking jaw forward to reach behind the locking ring and seat the gripping edge securely into the grooved lip.

Step #3

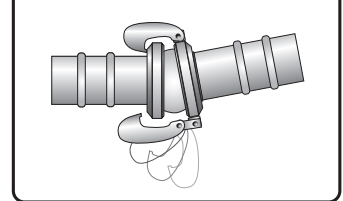

Step 4*:

Finally, ensure that the leading edge of the ball is aligned just enough so that it does not cut into the O-ring surface, then (with 12" fittings) insert the leverage bar into the hole provided on the base of the "long" jaw and pull back toward the barbed shank to lock the ball into the socket.

Step #4

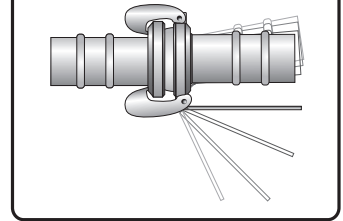

***NOTE:** 10" A-Style Wil-loc female/socket fittings have lever locking handles permanently attached to the "long" jaw mechanism. Locking action is similar to the B-Style lever arm.

For additional information about the assembly or use of Wil-loc® Quick Coupling products, contact customer service at 1-800-801-0123.